

BERNINA EMBROIDERY SOFTWARE 9

*Design your dreams
Create your ideas*



made to create **BERNINA**

RELEASE NOTES

V9 – July 2024

These Release Notes contain descriptions of all features and improvements in the BERNINA Embroidery Software product range new to this release. The BERNINA User Manual contains descriptions of all product features as of the last major release. Every effort has been made to ensure their accuracy.

© 2024 Corel Corporation. All rights reserved. CorelDRAW® SE is provided under an enclosed license agreement that defines what you may do with the product and contains limitations on warranties and your remedies. © Copyright 1997-2024 Wilcom Pty. Ltd., Sydney Australia. All rights reserved.

INTRODUCTION

Welcome to BERNINA Embroidery Software 9, created to Design your Dreams.

The best domestic machine embroidery software available today, BERNINA V9 is designed specifically for the hobbyist and home business. It includes all the features and tools needed to create and produce embroidery designs with BERNINA embroidery machines.

BERNINA V9 users are generally home craft embroiderers and sewing craft enthusiasts who already do machine embroidery or who are keen to learn it. You may be someone who has bought a new BERNINA embroidery machine or already own an embroidery machine for home hobby and craft purposes.

If you are new to BERNINA Embroidery Software 9, you'll be pleased with its flexible digitizing capabilities, the ease with which you can create and edit designs, and how simple it is to add or create your own lettering. However, before you begin working with the product, please read **Getting Started** (Reference Manual). This chapter presents an overview of the basic concepts of digitizing with BERNINA V9 and provides you with important guidelines on how to use this software to achieve the best results.

BERNINA Embroidery Software 9 is an enhanced version of our earlier products. It has many new and expanded features. Please read the Release Notes available from the **Help** menu to quickly familiarize yourself with the scope of these improvements.

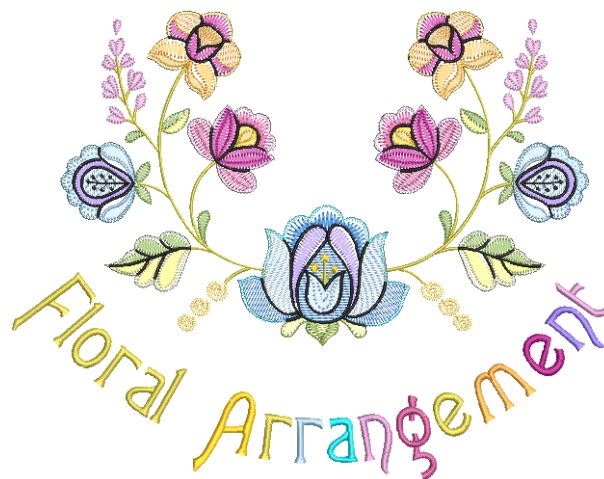

Product levels

BERNINA Embroidery Software 9 consists of the following product levels:

Level	Capabilities
DesignerPlus	Full digitizing capabilities. This model also incorporates CorelDRAW Graphics as standard, as well as Cross Stitch and Quilter applications.
Creator	This is the BERNINA V9 mid-level product. It provides capabilities for embroidery modification and digitizing.
ARTLink	This base level supports BERNINA machines with direct linking. It also provides some design editing capabilities such as scaling.



Note BERNINA V9 DesignerPlus is unique in providing seamless integration with CorelDRAW® SE, the most popular vector-based drawing package for home users. This combination offers a more efficient, user-friendly approach to embroidery design by combining the embroidery capabilities of BERNINA V9 with graphical capabilities of CorelDRAW®. It also allows users to create not just embroidery, but true, multi-medium designs. Visit also CorelDRAW® [Online Help](#) to get the best out of this powerful package.

Key features

BERNINA Embroidery Software 9 benefits from the following key features...

Feature	DesignerPlus	Creator
Improved user experience		
Product levels – mid-level Creator and top-level DesignerPlus	●	●
New look installation & registration		
<ul style="list-style-type: none"> • Greater flexibility for use of software on different computers • No need for security dongles 	●	●
Integrated CorelDRAW® SE	●	
Home Screen		
<ul style="list-style-type: none"> • Easy access to software features • Landing page 'Home' • Tutorials & Help • Skill builder • BERNINA blog • BERNINA webinars • Embroidery designs shop 	●	●
User interface		
<ul style="list-style-type: none"> • New Lettering / Monogramming toolbox • New Appliqué toolbox • Combined CutWork / StumpWork toolbox • Design types – grade A, B, C, and D – now indicated on Status bar. 	●	●
Embroidery Library		
<ul style="list-style-type: none"> • Improved design library preview on right side • New incorporated Keyboard Design Collection docker • New 'Send Selected Design to BERNINA WiFi Device' tool. 	●	●
Customer Experience Program includes an 'opt out' option	●	●
Documentation – new online help and PDFs for onscreen viewing and print	●	●
Software enhancements		
New Appliqué toolbox which includes:		
<ul style="list-style-type: none"> • Digitize Appliqué with Holes • Convert to Appliqué • Combine Appliqué • Export Cutting File tools • Improved appliqué properties controls. 	●	L
Auto-digitizing improvements	●	●
Branching – for fills (not only outlines)	●	●
Outlines & Offsets – multiple offsets	●	●
Weld function – combine objects into one object shape	●	●
● Included as standard ○ Extra-cost option L Limited functionality		

Feature	DesignerPlus	Creator
Improved CutWork <ul style="list-style-type: none"> • Cutwork and stumpwork functions combined • New Digitize Open Cut and Digitize Closed Cut tools • Improved Digitize Piece tool • New Convert to CutWork Border tool • Combine Selected function incorporated in toolbox. 	●	L
New Keyboard Design Collection Assign character designs to keyboard characters in a keyboard design collection for use with lettering and monogramming.	●	L
Export SVG files from Embroidery Canvas as EXP	●	●
Improved machine networking		
New BERNINA WiFi Device to enable WiFi connection for new and existing machines.	●	○
New content		
<ul style="list-style-type: none"> • New fonts • New patterns • New fabrics • New designs 	●	●
● Included as standard ○ Extra-cost option L Limited functionality		

System requirements

Before you install the software make sure your computer meets the technical system requirements detailed below.

PC specifications

Check that your PC meets the system requirements. Check CPU/RAM as well as hard disk space. The table below provides minimum system requirements.

Component	Minimum	Recommended
CPU	Intel® Core i3 or AMD Ryzen 3	Intel i5/7 processor or AMD Ryzen 5/7
Operating system	Microsoft Windows 10 or Windows 11 (64-bit editions), with the latest updates	
Browser	Microsoft Edge or later	
Memory	8 GB	16 GB or more
Hard disk size	80 GB	256 GB or more (solid state drive)
Free disk space	† 40 GB	60 GB or more
Graphics card	Support for Highest Color (32bit) and resolution (1366 x 768)	Support for Highest Color (32bit) and resolution (1920 x 1080 or higher)
Monitor	¥ 1366 x 768 screen resolution	Dual monitors capable of displaying 1920 x 1080 screen resolution
Mouse	USB mouse	
USB port	Required for data transfer (designs to USB stick) and configure BERNINA WiFi Device.	
Sound card	Required for online video help.	
Internet connection	Internet connection required to sign in to authenticate BERNINA V9, receive software updates and access online content. You can use the software offline provided you connect to the Internet at least once every 30 days so that we can validate your software license. You will not have all features while working offline.	

Free hard disk space †

BERNINA V9 occupies up to 5GB of hard disk space, depending on options installed. CoreIDRAW® SE also takes up an additional 3GB.

Screen resolution ¥

Some controls may be hidden on the user interface if you run your monitor at low resolutions. The physical size of your monitor will have a bearing on the optimum screen resolution. Larger fonts will exacerbate the problem. If you experience visibility issues, try adjusting both screen resolution and font size. For example, a resolution of 1600 X 900 with a font size of 100% or 125% should be acceptable.

Information for Mac OS X / Apple users

BERNINA V9 can be installed on Intel-based Mac computers using **Boot Camp** to run Windows 10/11 on a dedicated partition. A partition of at least 85GB is required, 100 GB is recommended. Using the software with Parallels to run Windows on a Mac OS is only supported on a limited basis and the following should be noted: [FAQ](#)

System security

The software is shipped with a product key which can be found inside the software kit. Each product key allows your system to be uniquely identified. You will be prompted to enter the product key to register and activate the product when the software is launched the first time following installation. Please keep the product key in a secure place.

Each licensed copy of the software is for a single user. It entitles you to install the product on up to three (3) devices, but you may only run the product on one (1) device concurrently. This restriction does not apply to BERNINA WiFi Connector which can be run on a second computer at the same time as you are running BERNINA V9.



Note All computers must use the same login details – email address and password. Should you wish to run the software on another computer, you must first sign out and ‘release’ the license from the current computer. This can be done via the **File > Sign Out and Release License** command.

Installation

BERNINA Embroidery Software 9 is a 64-bit application. You’ll notice a big improvement in speed and performance over the older 32-bit systems. It is installed in the 64-bit folder:

```
C:\Program Files\BERNINA\DesignerPlus 9\
```

You can, however, still run previous versions of BERNINA Embroidery Software on the same computer.



Note If you are upgrading from a previous version of the software, you are advised **not** to remove any earlier versions until after installing the new software. This gives you the option of merging user-defined settings, including custom patterns, into the new installation.

Custom assets

BERNINA Embroidery Software 9 allows you to create files or ‘assets’ of various kinds during normal use. The most important of these are of course actual embroidery designs. These are located by default in the built-in **Embroidery Library**. See [Embroidery library](#) (Reference Manual).

Asset files which you have created yourself may include hoops, patterns, monograms, and others outlined below. These assets are preserved from installation to installation, whether installing a new version of BERNINA V9 or an update patch. In order to preserve any custom assets, do not uninstall your existing version of BERNINA V9. Custom data is installed by default to this folder...

C:\ProgramData\BERNINA\BERNINA Embroidery\DesignerPlus 9\
Custom assets are then located in these sub-folders...

Custom assets	Location	File types
Borders	..\BORDERS	*.ESA
Hoops	..\RES\Hoops	USRHOOPS.DSC
Fabrics	..\Fabrics	userdefined.autost
Patterns	..\MOTIFS	*.ESA
Quilt blocks	..\Blocks	*.BLB
Stamps	..\STAMPS	*.ESA
Templates	..\TEMPLATE	*.EMT
Thread charts	..\RES\ThreadCharts	*.TCH



Note If you want to move BERNINA Embroidery Software to another PC, you will need to manually transfer any custom assets you have created or received from third parties.

Related topics...

- ▶ [Asset locations](#) (Reference Manual)

License management

You may have received a 5-part BERNINA V9 product key in the form:

566695e-dedc-4417-a5e7-8326056cd267

This allows you to register an account in order to run BERNINA Embroidery Software.

Install the software

Before commencing, make sure you have the following...

- ▶ Software product key which is located in the kit.
- ▶ If you are updating from V6–V7, you will need your hardware dongle. Do not attach until prompted.



- ▶ If you are updating from V8, you will be prompted to enter your existing product key. If you no longer have it, use the email address that was used for registration. If this is no longer known, please contact [BERNINA Support](#).

- ▶ In addition to the technical system requirements, make sure that:
 - ▶ Anti-virus is temporarily disabled
 - ▶ You have administrator rights.

To install the software...

- 1 Ensure your computer meets the technical requirements for the software. See **System requirements**, pg 3 for details.
- 2 Close all MS Windows® applications and temporarily disable your anti-virus software.
- 3 If you have purchased BERNINA V9, uninstall any previous versions of CorelDRAW®.
- 4 Insert the Installation USB Stick in the USB port of your computer and wait for the welcome screen. Alternatively, start the installation manually by double-clicking the setup.exe on the stick.



- 5 Follow the onscreen instructions to complete the installation. You will be prompted as follows...

Option	Details
License agreement	Check the license agreement before proceeding. Optionally, print the agreement to obtain a hard copy.
Setup type	Choose a setup type – complete or custom. If you are updating or installing a new copy, choose to install the complete version.
Extra languages	The installation will default to the language of your operating system. Install additional languages as preferred. These can be switched anytime via the BERNINA program group.
Destination location	By default, the software will install to the 'Program Files' of your operating system. Change locations if necessary.

- 6 Click **Install** to proceed.

- 7 If you have purchased BERNINA DesignerPlus, a copy of CorelDRAW® SE will be automatically installed, allowing you to take advantage of the integrated **Artwork Canvas**.



Note If you are installing CorelDRAW® SE, you will need to create Corel account or use an existing Corel account in order to activate the software.

- 8 Reboot the PC when prompted. Save any files and close all applications beforehand.

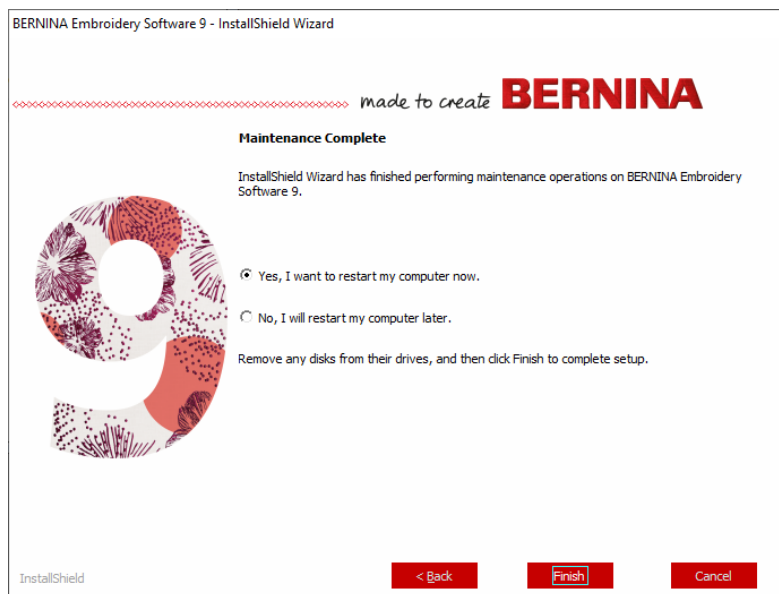

- 9 Double-click the desktop icon to start BERNINA Embroidery Software 9. To sign in you will first need to register your account. See **Register your account** below for details.

- 10** When first running BERNINA DesignerPlus, a CorelDRAW® integration message will appear. Choose 'Install link to CorelDRAW' to take advantage of the integrated **Artwork Canvas**.

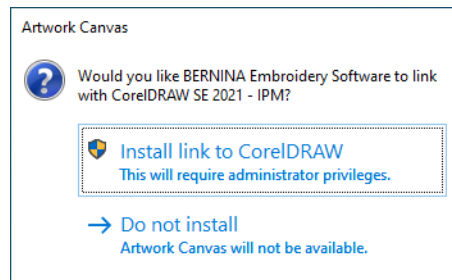

Register your account

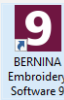

Double-click to start BERNINA Embroidery Software.

You will need to register an account in order to run BERNINA Embroidery Software.

To register your account...

- 1 Double-click the desktop icon to start BERNINA Embroidery Software 9. The below 'sign-in' screen appears. To sign in you will first need to create an account.

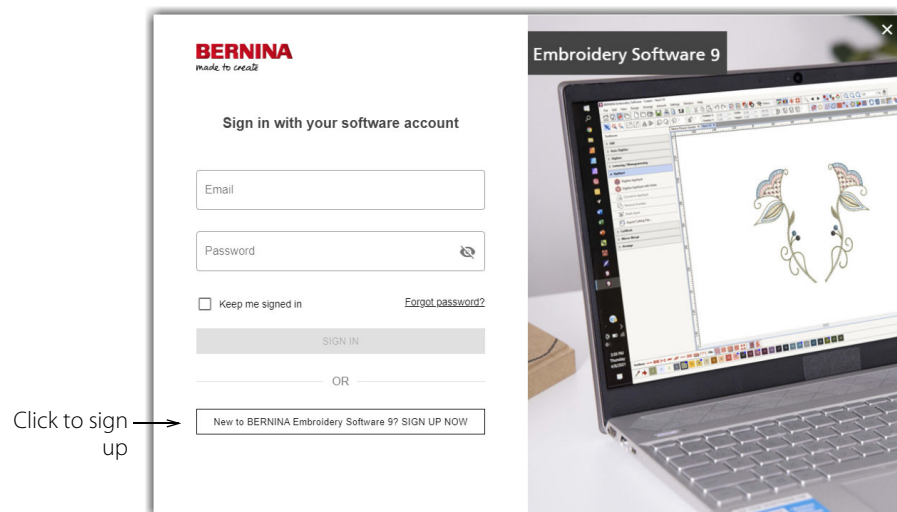

- 2 Click the 'Sign up Now' button and follow the onscreen instructions. An internet connection is required for this step.

You will be prompted to create an account.

Enter account details →

Click to create account →

3 Fill in the details and click **Create**. You will be prompted to enter additional details.

Fill in additional account details →



Note When updating your software, use the same email address used when registering your V8 software. The system will then automatically match the new product key with the old.

- 4 Fill out these details and click the 'Create Account' button. The next screen is the verification screen.

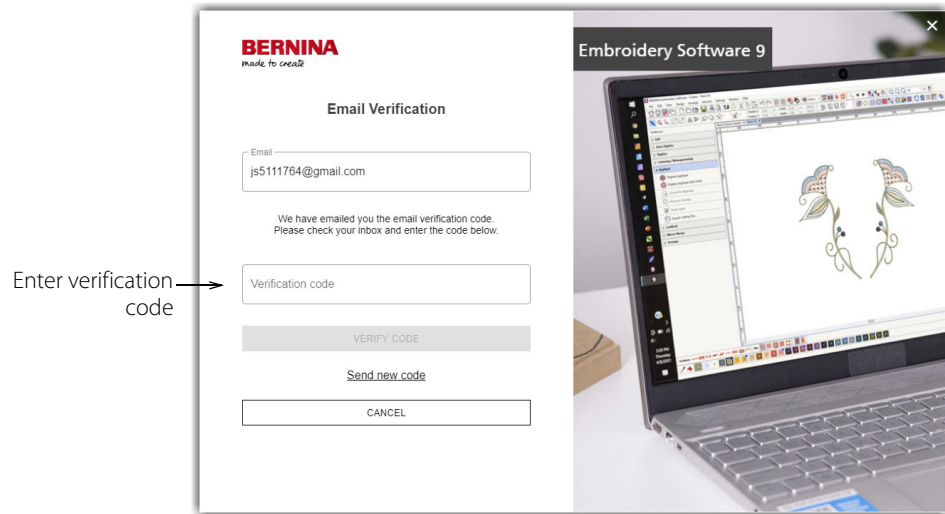

A verification email will be sent to the registered email address.

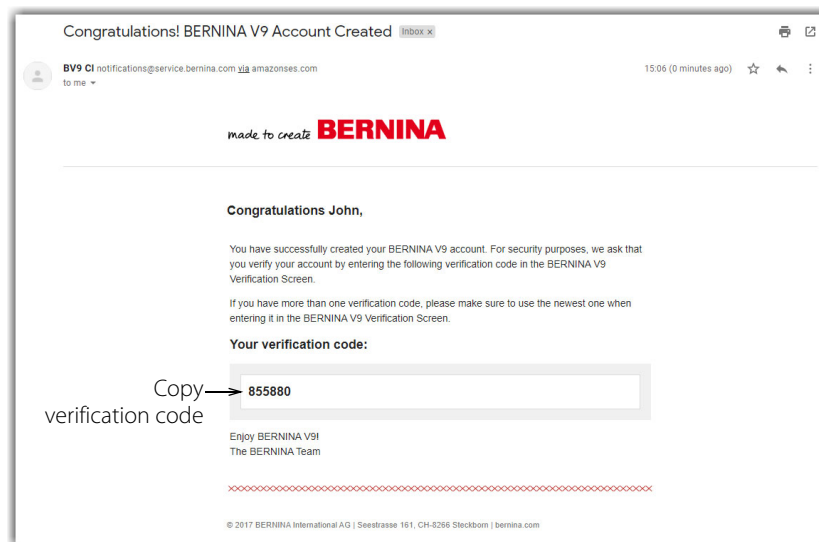

Tip If the email does not appear shortly, check the SPAM folder. If necessary, click the 'Send new code' button.

- Once received, copy the code in the email – select and press **Ctrl+C** – and paste it into the verification code field.

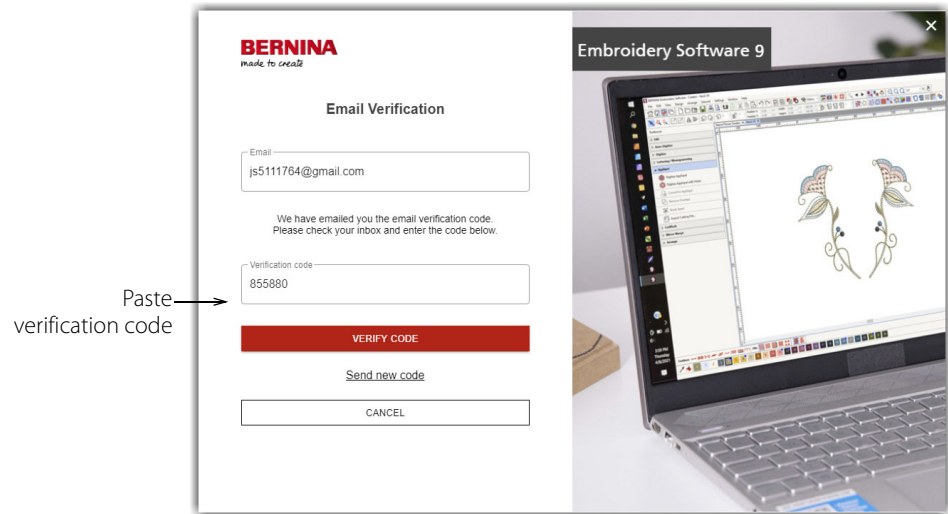

- Click the 'Verify Code' button. You'll be prompted to enter the product key.

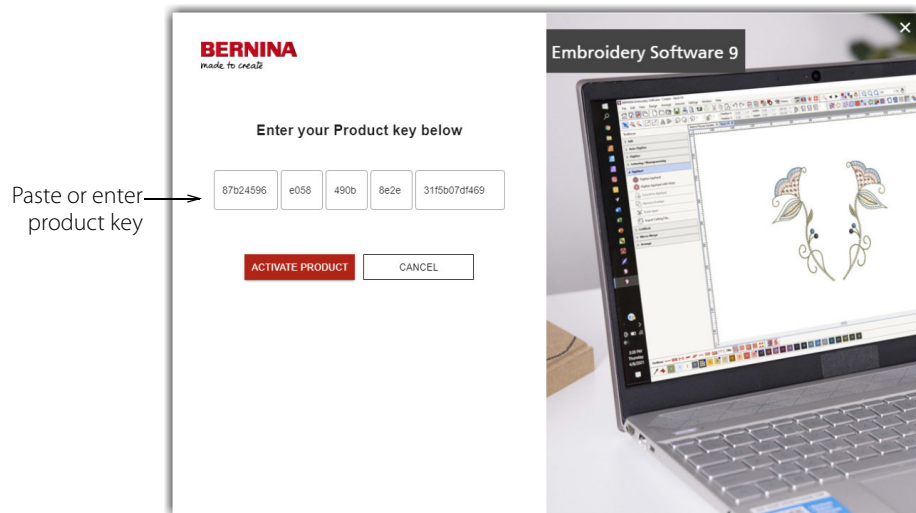

- Enter the product key if you have it, and click the 'Activate Product' button. If you are updating from an earlier version you will be prompted to select the current software

version you are using. This will only happen if the software is not able to detect your existing version.

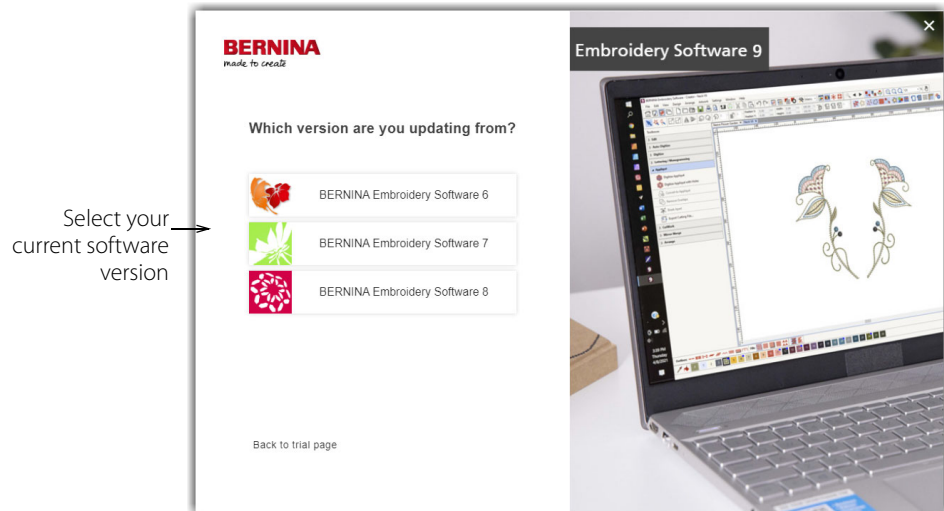

- 8 Click to select your current software version. You will be prompted to attach your dongle to the PC in order to update.

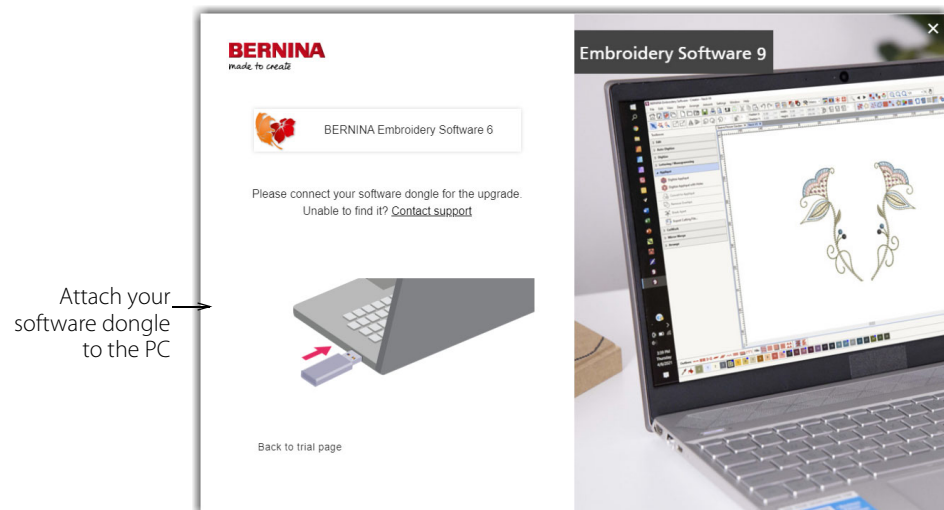

Upon successful detection of your current dongle or software key, the process will continue automatically. The hardware dongle is deactivated and can be discarded following a successful update.

Modify your installation

Whether you are updating your current software or wanting to uninstall it, you follow the same procedure. When you re-run the installation program, it will automatically detect any existing installation and give you an option to modify, repair or remove it. This will prevent installation of more than one release on your computer.

To modify an existing installation...

- 1 Close all MS Windows® applications but leave Windows running.

2 Insert the Installation USB.

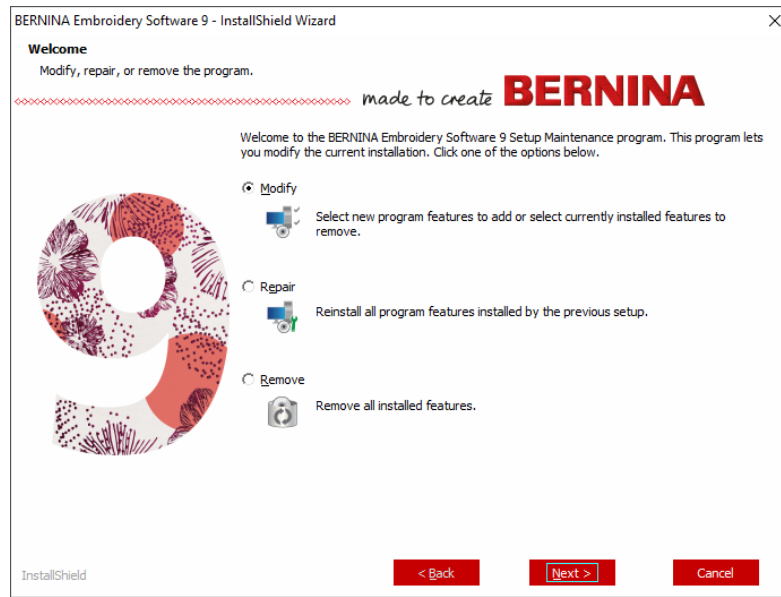

3 If the software is already installed on the computer, you will be prompted to:

Option	Notes
Modify	Change selection of installed components.
Repair	Reinstall same components.
Remove	Uninstall the software.

Upon successful installation of the software, the **Maintenance Complete** screen appears.

Periodic updates

Periodically you will receive automatic updates to your software installation. These will include improvements and fixes to known problems. If you are uncertain about your current status, you can manually check for updates.

To check for updates...

- 1 Connect your computer to the internet.
- 2 Start BERNINA Embroidery Software 9. It will automatically check for software updates. Alternatively, go the **Help** menu and choose **Check for Updates**.

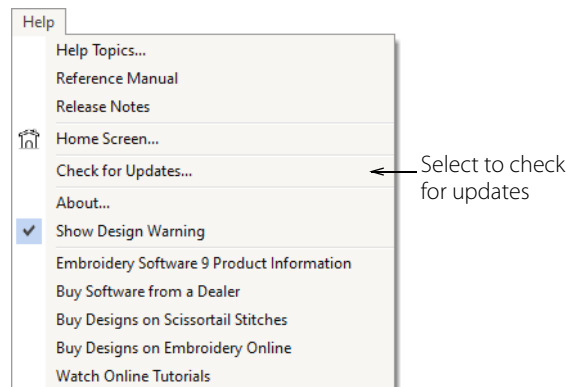

If the installation is not up-to-date, you will be prompted to start the update. The required file will be downloaded from a secure server.

- 3 Once download has completed, follow the prompts.
- 4 Once the update is complete, you will need to restart your PC for changes to take effect.



Tip Automatic updates overwrite your 'normal' template. If you have made changes, you will need to save them to a custom template – e.g. 'My Template'.

Integration with CorelDRAW®

BERNINA DesignerPlus is unique in providing seamless integration with CorelDRAW® SE, the most popular vector-based drawing package for home users. This features 'best-of-breed' bitmap-to-vector tracing, enhanced illustration capabilities, photo-editing together with a library of professional clipart images.

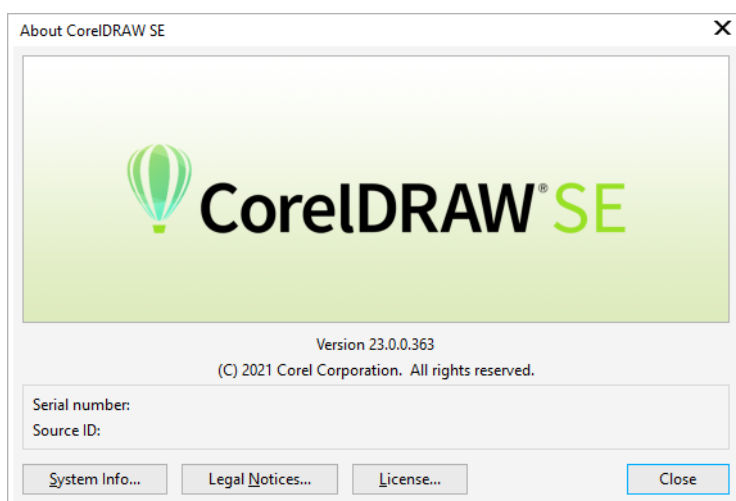

The integrated **Artwork Canvas** provides access to all the CorelDRAW® SE drawing tools. These offer many techniques for drafting outlines and shapes on screen. Vector objects can be converted to embroidery designs. It also allows users to create not just embroidery, but true, multi-medium designs. For a description of the tools, use the online help available from the **Artwork Canvas Help** menu. The same menu provides access to Corel Video Tutorials and other valuable resources.



Note CorelDRAW® SE is installed together with Windows .NET Framework. Make sure you install it when prompted to do so. It can take up to 20 minutes or more to install the .NET Framework on some computers.

Hardware setup

Different devices are set up in different ways – some in MS Windows®, via the Control Panel, others within BERNINA Embroidery Software 9 itself. For instructions on connecting devices to your computer and setting up in MS Windows®, see the documentation for the device as well as your MS Windows® documentation.

Set up embroidery machines

We recommend using the dedicated BERNINA WiFi Device for cable-free communication between computer and machine. The BERNINA WiFi Device is provided with most BERNINA V9 products. It can also be purchased separately. The concept behind the BERNINA WiFi Connector network is described by the following diagram...

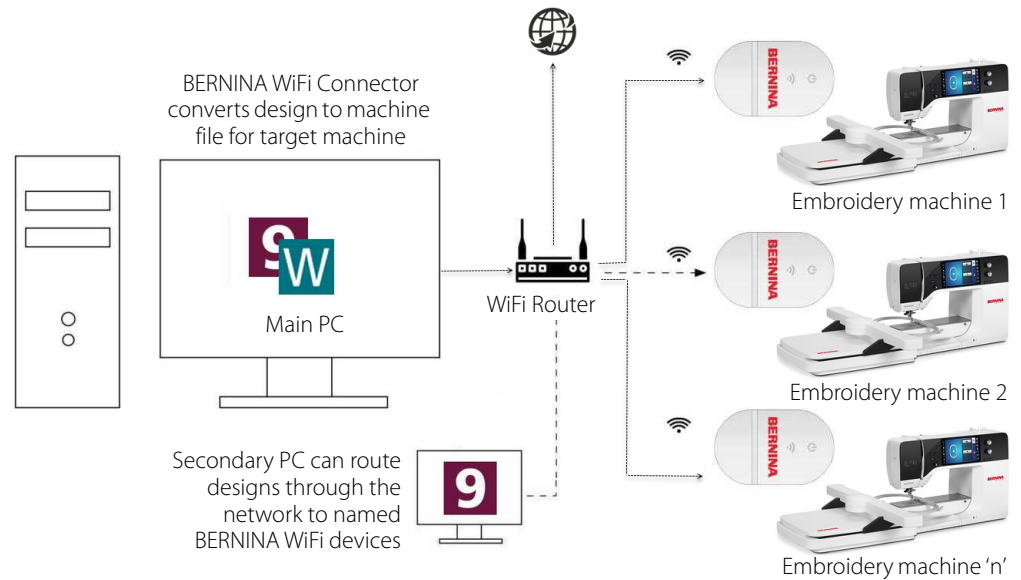

In the above configuration, designs are transferred to BERNINA WiFi Device via the main PC running the BERNINA WiFi Connector application. They can either be sent directly from the main PC or from a second PC. See **Machine Networking** (Reference Manual).

Set up scanners

BERNINA Embroidery Software 9 supports TWAIN-compatible scanners.



Note Some scanners will not work with BERNINA V9 because they require their own scanner software. If this is the case with your scanner, use your scanner software for scanning, save the image to your hard drive, then load the image into BERNINA V9.

To set up scanners...

- 1 Connect the scanner using the accompanying instructions.
- 2 Set it up in MS Windows® using the accompanying instructions and/or the Microsoft MS Windows® documentation.
- 3 Start BERNINA Embroidery Software 9.
- 4 Select **Settings > Scanner Setup**. The **Select Source** dialog opens displaying a list of scanner drivers loaded on your computer.

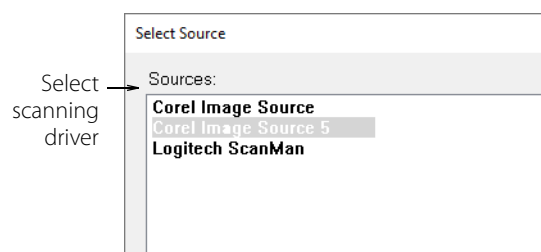

- 5 Select the scanning driver to use, then click **Select**.



Note If you have trouble with scanning after re-starting BERNINA Embroidery Software 9, there may be a conflict with previously installed scanner drivers. Re-install BERNINA V9 and test the scanner. If the selected scanner driver does not work in BERNINA V9, select another scanner driver from the list. There are usually two installed for each scanner.

Screen calibration

The **Screen Calibration** dialog lets you calibrate your monitor to ensure that designs at 1:1 scale display at the actual size of the final embroidery.

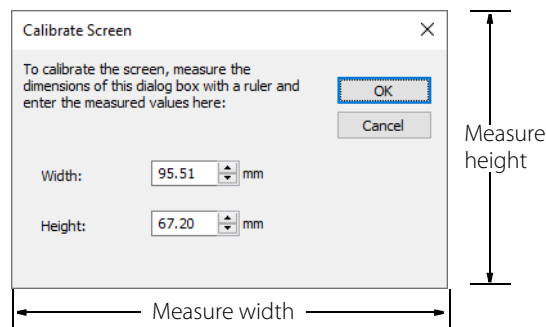

Resources & support

BERNINA Embroidery Software 9 provides various ways to access information about the software and how to use it. It also provides links to sources of ready-made embroidery designs.

Resources

Onscreen documentation is provided in two formats – Online Help and Adobe Acrobat.

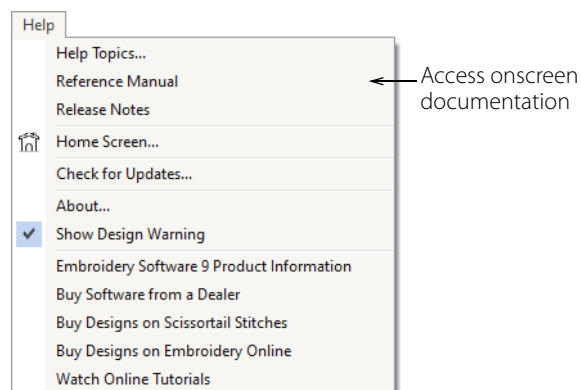

Depending on your product level, documentation components will include some or all of the following:

Release notes

A set of release notes is included with the software installation. These provide detailed information about new and improved features as well as direct links to the relevant sections of the Reference Manual.

Reference manual

The Reference Manual provides detailed procedures covering all features of the **Embroidery Canvas** and **Embroidery Library**. It contains step-by-step instructions together with samples and screen images. The BERNINA Cross Stitch and BERNINA Quilter applications are documented in supplementary manuals. Copies are available for download via the online help main page.

Online help

Online help provides quick access to general information on BERNINA V9 features and step-by-step instructions. An **F1** keypress accesses context-sensitive help.

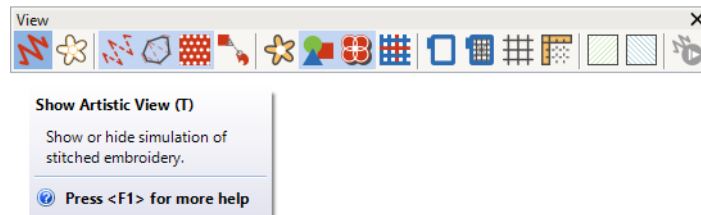

Online resources

There are many other sources of ready-made embroidery designs which you can purchase and adapt as you wish. The **Embroidery Canvas Help** menu directs you to two rich sources – Scissortrail Stiches and OESD Embroidery design studios.

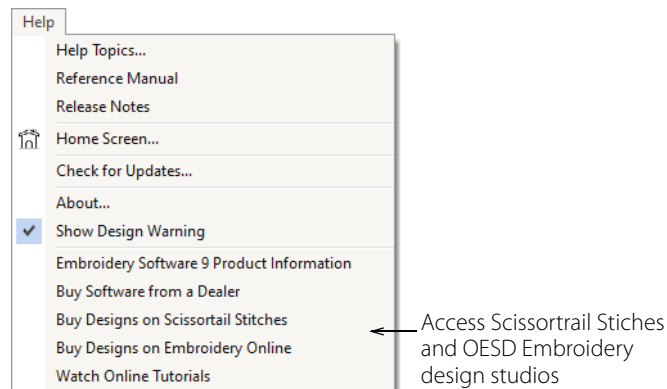

Note For a description of the CorelDRAW® tools available in **Artwork Canvas**, refer to the online help available from the **Artwork Canvas Help** menu. The same menu provides access to Corel Video Tutorials and other valuable resources.

Feedback reporter

BERNINA V9 includes a feedback reporter, when connected to the internet, to provide direct contact with **BERNINA Support** following a system crash...

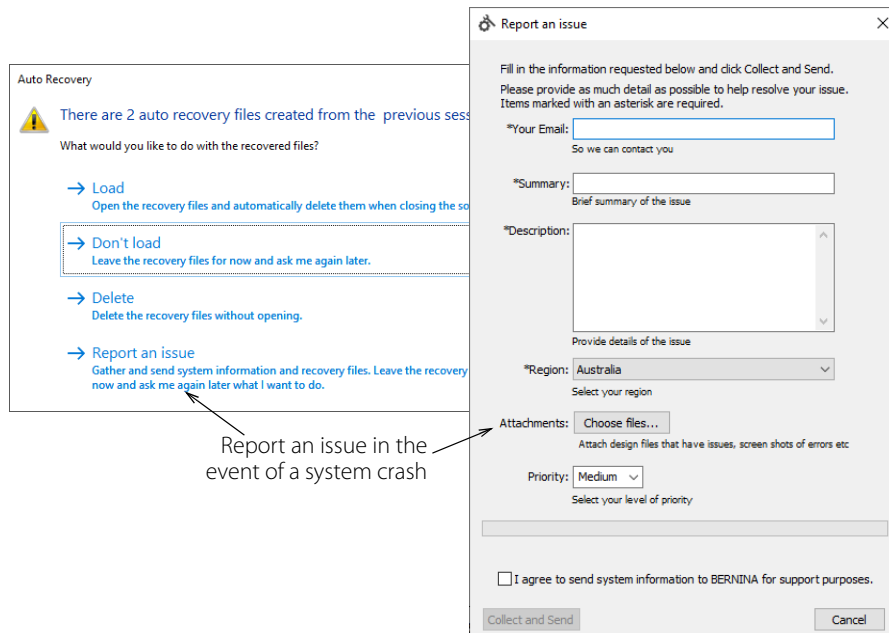

Use the issue reporter to request assistance for specific issues. The reporter can also be run independently from the BERNINA V9 program group.

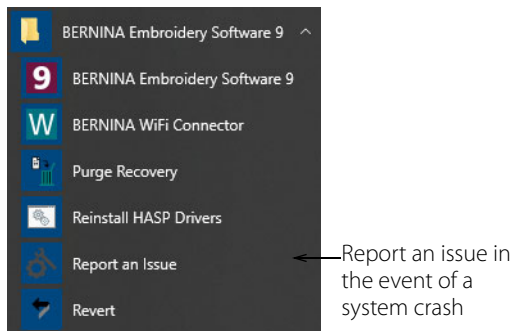

Conventions used in the documentation

The following conventions are used throughout the documentation.





Commands

Commands on a menu or submenu are referred to by both the menu and command names. For example the 'Dim Artwork' command in the 'View' menu is referred to as **View > Dim Artwork**.

Dialog boxes

Dialog boxes are referred to as 'dialogs' and are shown in the manual only if they provide important information on using BERNINA Embroidery Software.

Keyboard conventions

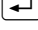
Instruction	Symbol	Action
Click		Click the left mouse button.
Right-click		Click the right mouse button.
Double-click		Click the left mouse button twice without moving the mouse.
Click OK	 or 	Click OK with the mouse or press the Enter key on the keyboard to complete the action.
Ctrl + S		While holding down the Control key (Ctrl), press the S key to save design.

WHAT'S NEW IN BERNINA EMBROIDERY SOFTWARE 9?

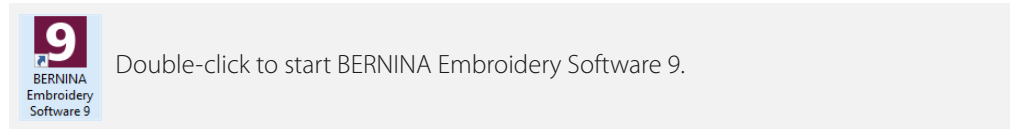

When you first run BERNINA Embroidery Software 9, you will see the updated interface shown below.

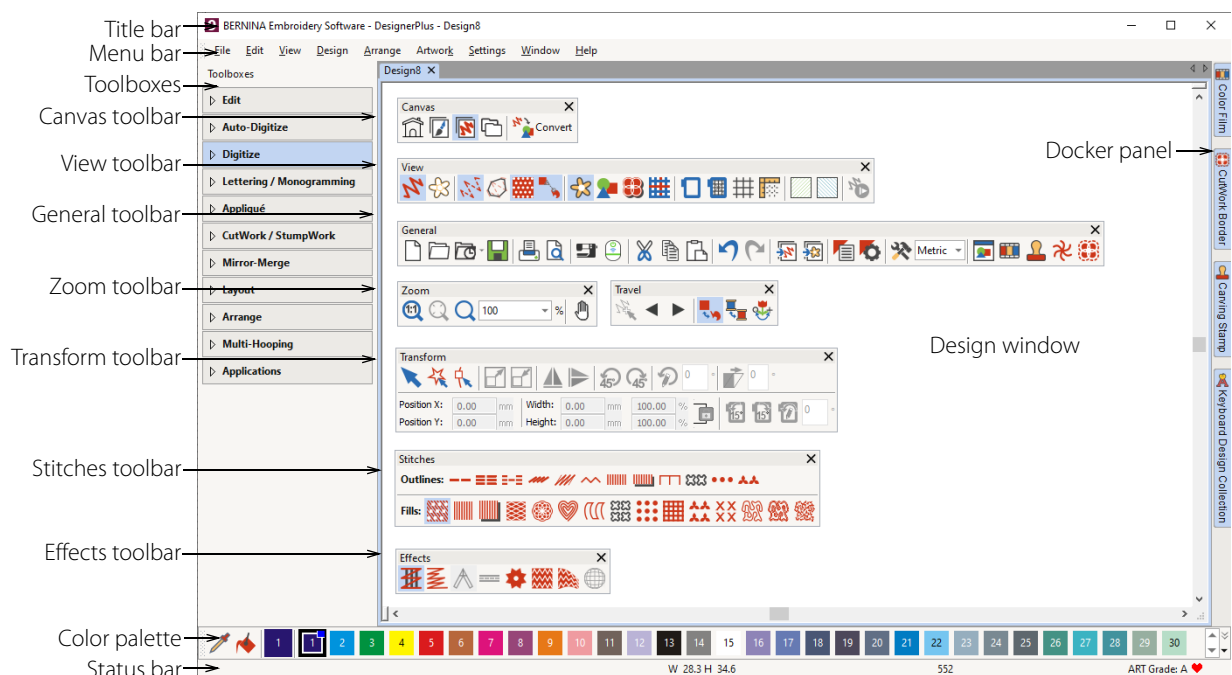

The BERNINA Embroidery Software 9 interface has same style and layout as BERNINA V8, including:

- ▶ Same style of button icons and toolbar organization
- ▶ Same toolbox menus on the left side
- ▶ Same command names and pulldown menus
- ▶ Same **Object Properties** dialog box.

However:

- ▶ There are new commands based on current command groupings
- ▶ Improved UI features on a case-by-case basis. See below.

General improvements

BERNINA Embroidery Software 9 benefits from the following improvements...

New 64-bit operating system support

The software now supports 64-bit operating system. You'll notice a big improvement in speed and performance. Note that 32-bit systems are no longer supported by BERNINA V9. It is installed in the 64-bit folder:

C:\Program Files\BERNINA\..

You can, however, still run previous versions of BERNINA Embroidery Software on the same computer. See also [System requirements](#) (Reference Manual).

New look installation & registration

BERNINA Embroidery Software 9 provides a 'new look' product account creation and activation method. This allows:

- ▶ Greater flexibility for use of software on different computers
- ▶ No need for security dongles.

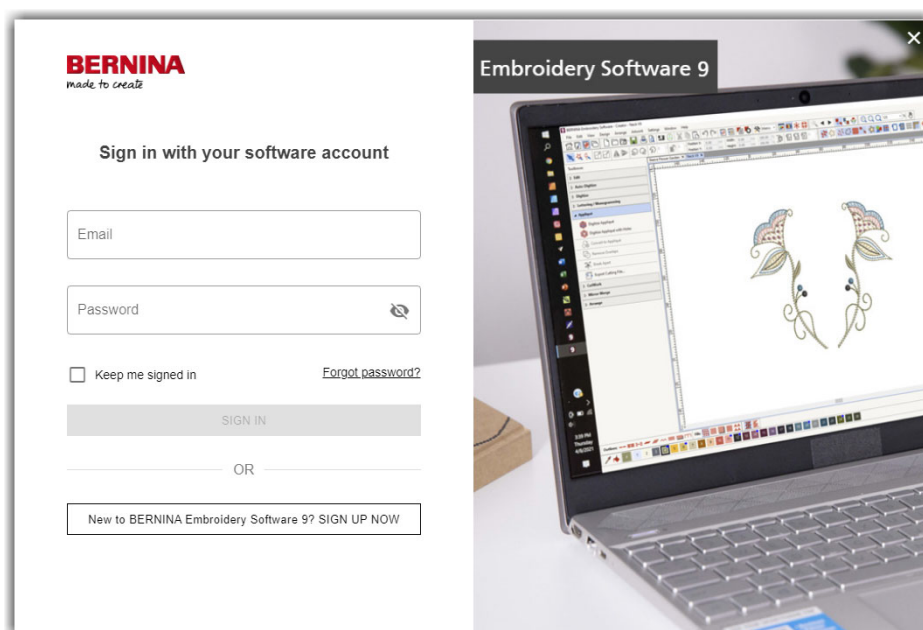

Each licensed copy of the software is for a single user. It entitles you to install the product on up to three (3) devices, but you may only run the product on one (1) device concurrently. This restriction does not apply to BERNINA WiFi Connector which can be run on a second computer at the same time as you are running BERNINA V9.



Note All computers must use the same login details – email address and password. Should you wish to run the software on another computer, you must first sign out and 'release' the license from the current computer. This can be done via the **File > Sign Out and Release License** command.

Related topics...

- ▶ [System requirements](#), pg 3
- ▶ [Installation](#), pg 4

BERNINA Embroidery Software 9 product levels

The BERNINA Embroidery Software 9 release provides the following range of product levels...

The screenshot shows the BERNINA Embroidery Software 9 interface. At the top left is the BERNINA logo with the tagline 'made to create'. In the center, it says 'Embroidery Software 9'. On the top right, there is a 'SIGN OUT' button. Below this, there is a 'BUY SOFTWARE' button. The main content area displays three product levels, each with a representative image and a list of features:

- ARTlink** (Image: Embroidered floral design on a dark fabric):
 - > Hoop Selection
 - > Design positioning template
 - > Customize printouts
 Includes a 'Learn more' link and a 'START' button.
- Creator** (Image: Embroidered bee on a white fabric with the text 'Bee Creative'):
 - > Home screen
 - > Convert to Appliqué
 - > Export cutting files
 - > Auto-Digitizing tools
 - > Full Editing tools
 Includes a 'Learn more' link and a 'Buy' button.
- DesignerPlus** (Image: Embroidered floral design on a white fabric):
 - > Home screen
 - > BERNINA WiFi-Device
 - > CorelDRAW
 - > Keyboard Design Collection
 - > Quilter
 Includes a 'Learn more' link and a 'Buy' button.

Each product level is geared to a different purpose...

Level	Capabilities
DesignerPlus	Full digitizing capabilities. This level also incorporates CorelDRAW Graphics as standard, as well as Cross Stitch and Quilter applications.
Creator	This is the BERNINA V9 mid-range product. It provides capabilities for embroidery modification and digitizing.
ARTLink	This base level supports BERNINA machines with direct linking. It also provides some design editing capabilities such as scaling.

Related topics...

- ▶ [Product levels](#), pg 1
- ▶ [System requirements](#), pg 3

Support for CorelDRAW



Use Canvas > Artwork Canvas to import, edit or create vector artwork as a backdrop for embroidery digitizing, manual or automatic.

BERNINA DesignerPlus comes with an installation of CorelDRAW® SE. The built-in **Artwork Canvas** includes CorelDRAW® drawing tools which offer many techniques for drafting outlines and shapes on screen. Vector objects can be converted to embroidery designs.

CorelDRAW® SE and its sister product, Corel PHOTO-PAINT® SE can also be run as standalone applications.

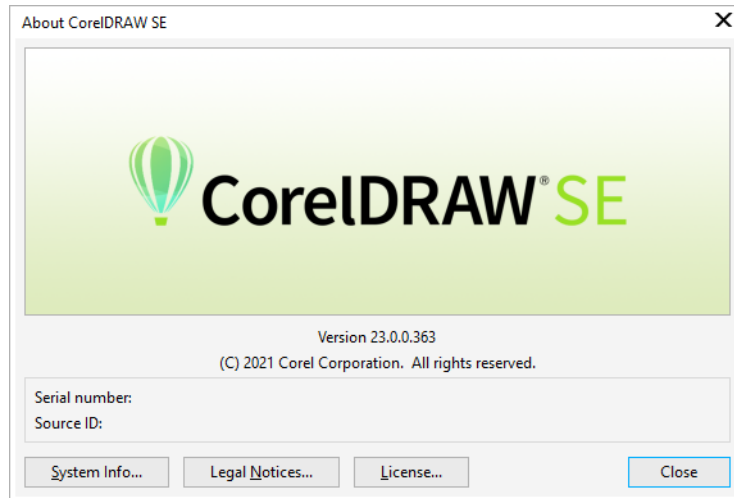

Pay special note to three new features of CorelDRAW® SE:

- ▶ CONNECT content
- ▶ Pointilizer
- ▶ Picture effects

See the **Artwork Canvas** Help menu for details.

Related topics...

- ▶ **Artwork canvas** (Reference Manual)

New Home screen

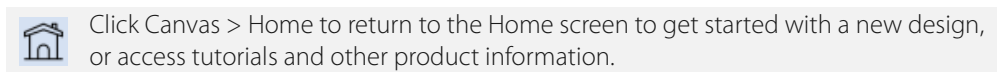

BERNINA Embroidery Software 9 now includes a home screen which establishes an integrated platform that will enable more up-to-the-minute communication with

BERNINA V9 users and improve overall user experience across software and website content.

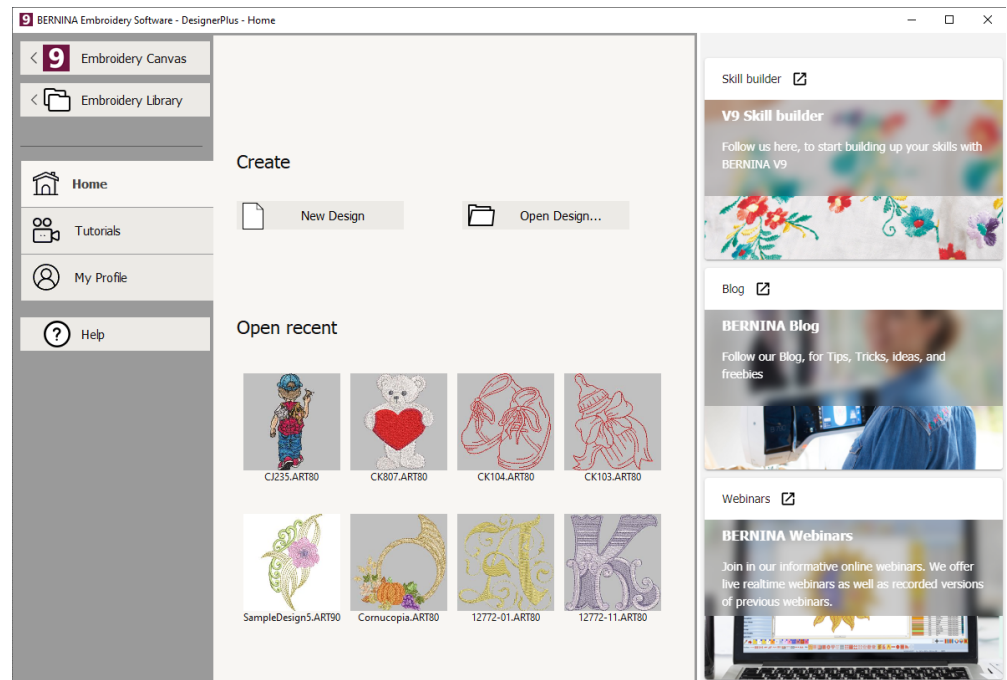

Related topics...

- ▶ [Register your account](#), pg 8
- ▶ [Home screen](#) (Reference Manual)
- ▶ [My profile settings](#) (Reference Manual)

Customer experience improvement program

BERNINA Embroidery Software includes a 'customer experience improvement program' designed to collect valuable data concerning software usage patterns. The program is entirely anonymous and is aimed at improving the features and functions of the software.

However, in BERNINA V9, you can opt out of the program altogether via **My Profile > Preferences**.

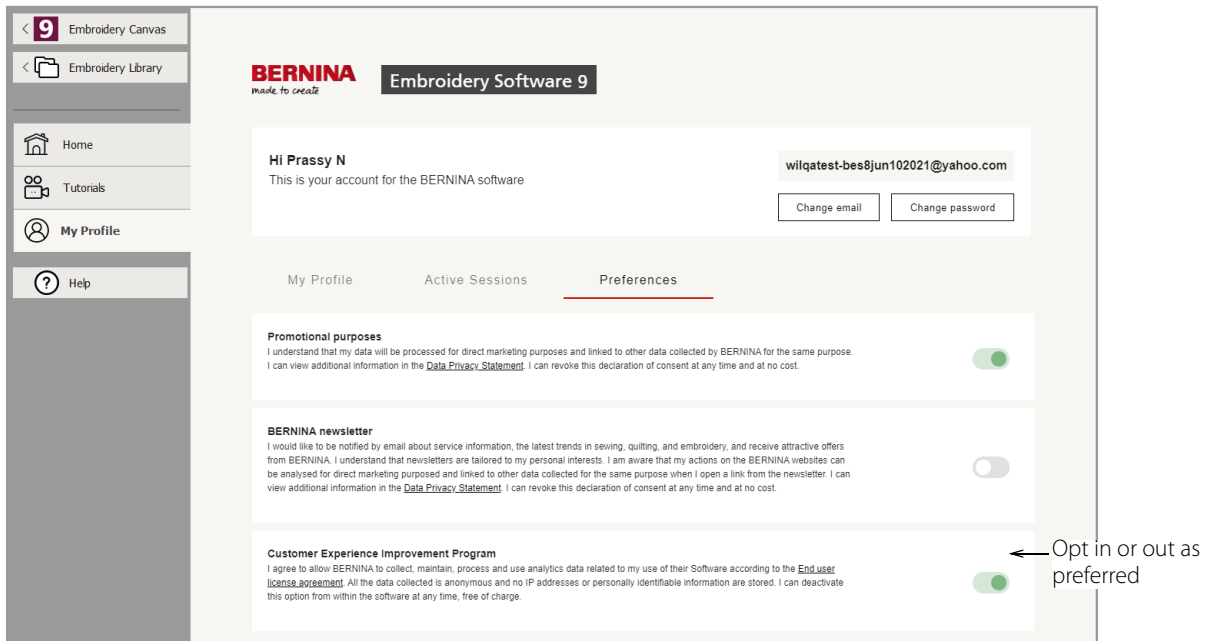

Related topics...

- ▶ **My profile settings** (Reference Manual)

Support for 4K high-res monitors

BERNINA Embroidery Software 9 supports 4K high resolution monitors. Buttons are large enough to be seen while allowing effective use of the large design window.

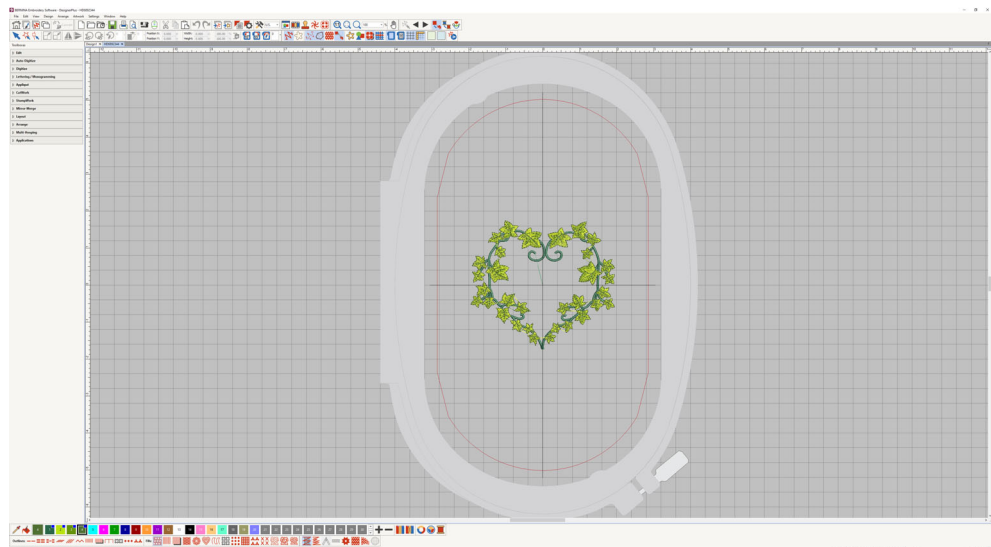

Note The user interface – e.g. toolbars, dialogs, text, etc – may appear too small on 4K monitors at 100% display scaling. The solution is to increase display scaling to a suitable value. The optimal scaling will depend on the monitor's resolution. We also recommend using large icons together with tool names. See the **Options > General** tab for settings.

New & improved lettering & monogramming

BERNINA Embroidery Software 9 provides the following lettering/monogramming improvements.

- ▶ A new **Lettering/Monogramming** toolbox has been added beneath the **Digitize** toolbox. Lettering and monogramming tools have been moved from the **Digitize** toolbox to the new toolbox.

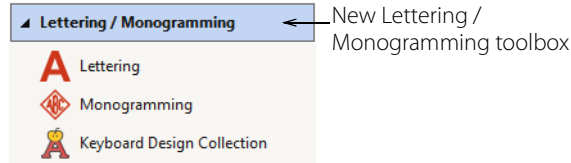

- ▶ New **Keyboard Design Collection** feature added to toolbox.
- ▶ Recommended minimum and maximum sizes for all embroidery fonts provided in software.
- ▶ Adjustable font preview size and number of recently used fonts in **Font** combo box.

Object Properties > Lettering tab

Currently the only source of information about recommended minimum and maximum sizes for embroidery fonts is the Reference Manual. Font size information is now displayed in the **Lettering** interface. Recommended minimum and maximum sizes are displayed next to the font name in the **Font** droplist, based on current measurement units.

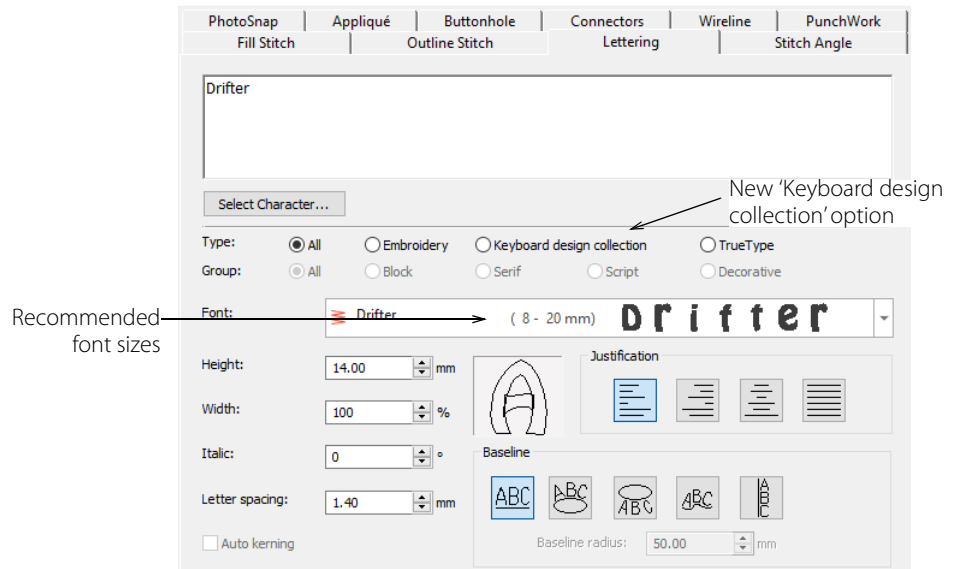

Other changes

- ▶ **Font** droplist shows recently used fonts and provides adjustable font preview size.

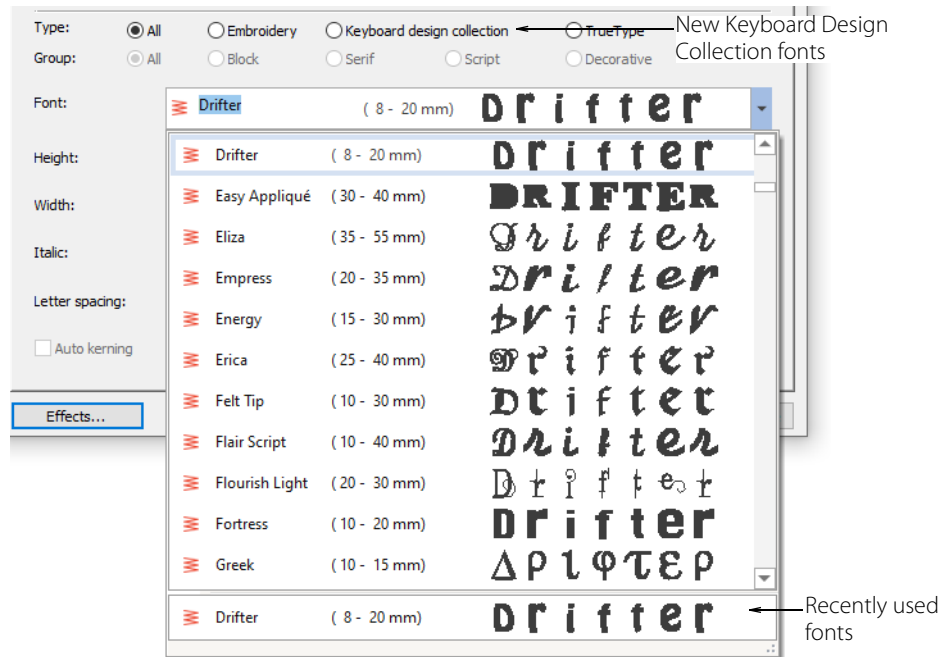

- ▶ 'Keyboard design collection' option available as font type.



Note Font list related controls – font preview size and number of recently used fonts – are included in the **General** tab of the **Options** dialog.

Related topics...

- ▶ [Create lettering via dialog](#) (Reference Manual)

New keyboard design collections



Use Lettering / Monogramming > Keyboard Design Collection to toggle Keyboard Design Collection docker display.

Many hobbyists buy embroidery character designs from third-party suppliers. These are very popular. Naturally, embroiderers want to be able to use them in BERNINA Embroidery Software by mapping them to keyboard characters. The **Keyboard Design Collection**

feature provides a convenient way to do this. Either, via the **Embroidery Library** (batch or one-by-one)...

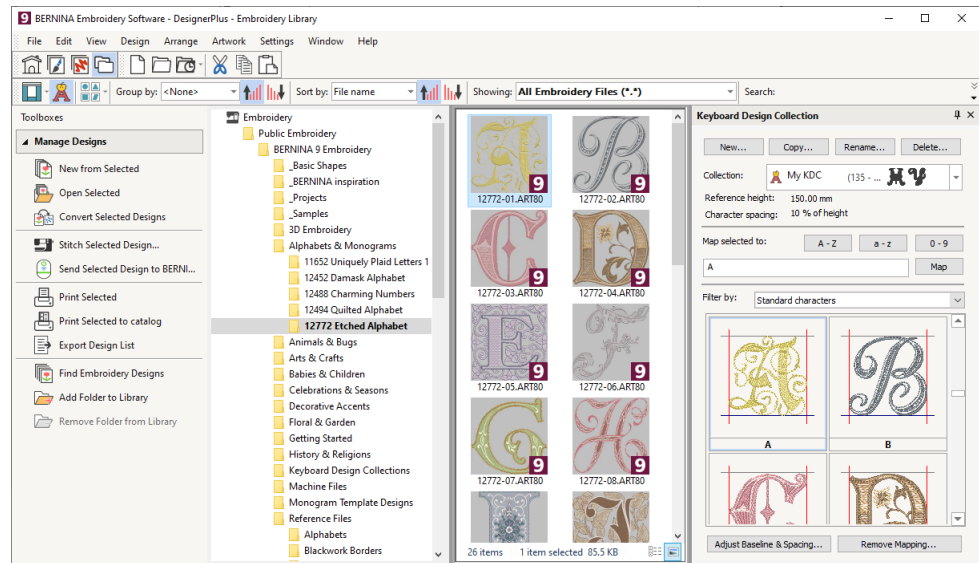

Or, via the **Embroidery Canvas** design window...

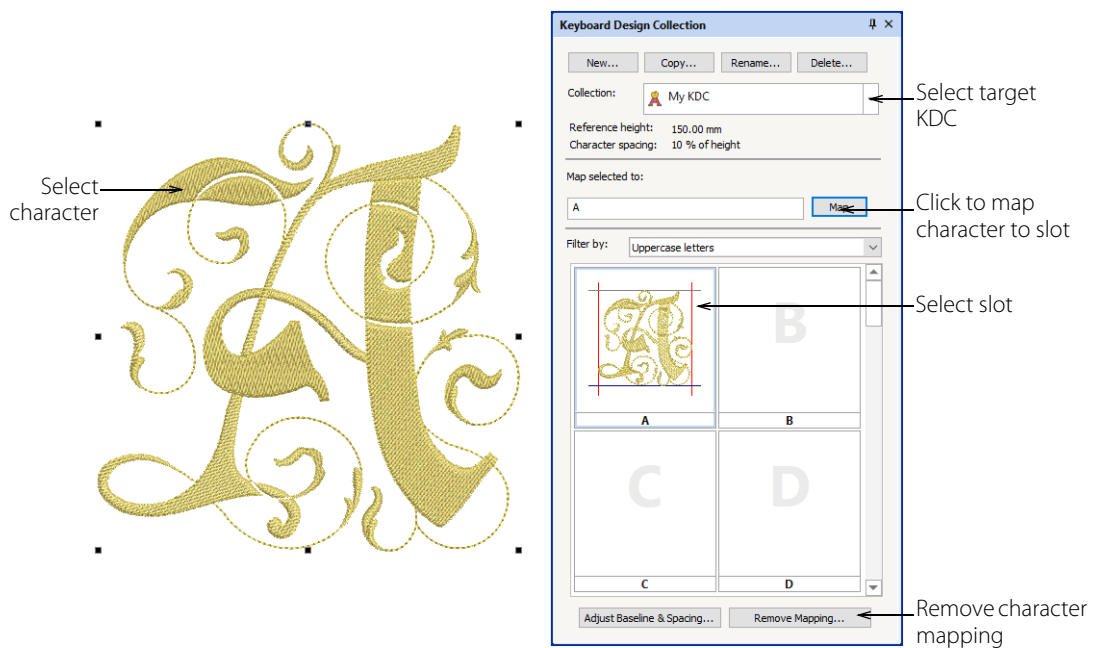

Related topics...

- ▶ [Keyboard design collections](#) (Reference Manual)

Appliqué improvements

BERNINA Embroidery Software 9 provides the following appliqué improvements.

- ▶ A new **Appliqué** toolbox
- ▶ A new **Convert to Appliqué** and other tools
- ▶ More stitch types for tackdown and cover stitching
- ▶ Greater control over appliqué component offsets
- ▶ Export current design or selected objects to SVG or EXP file format for cutting.

Appliqué toolbox

A new set of **Appliqué** tools has been added to the toolbox beneath the **Lettering** toolset.

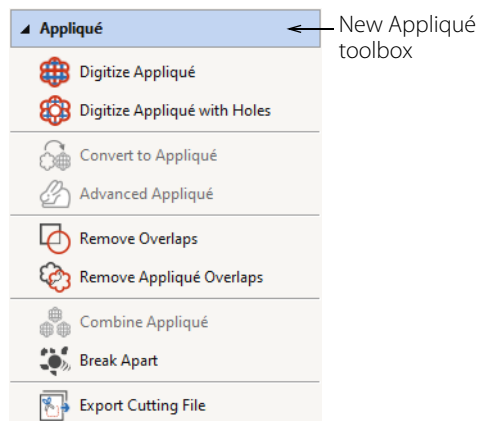

This toolbox contains all appliqué-related tools and incorporates the following changes:

- ▶ Existing **Appliqué** and **Advanced Appliqué** tools have been moved from the **Digitize** toolbox.
- ▶ The **Appliqué** tool is now called **Digitize Appliqué**.
- ▶ New **Digitize Applique with Holes** and **Combine Applique** tools have been added.
- ▶ The existing **Remove Appliqué Overlaps** tool has been moved from the **Edit** toolbox.
- ▶ The existing **Remove Overlaps** and **Break Apart** tools are now included in the **Appliqué** toolbox.

Related topics...

- ▶ [Digitizing for Appliqué](#) (Reference Manual)

Appliqué tab

The **Appliqué** tab in the **Object Properties** docker has been updated as shown:

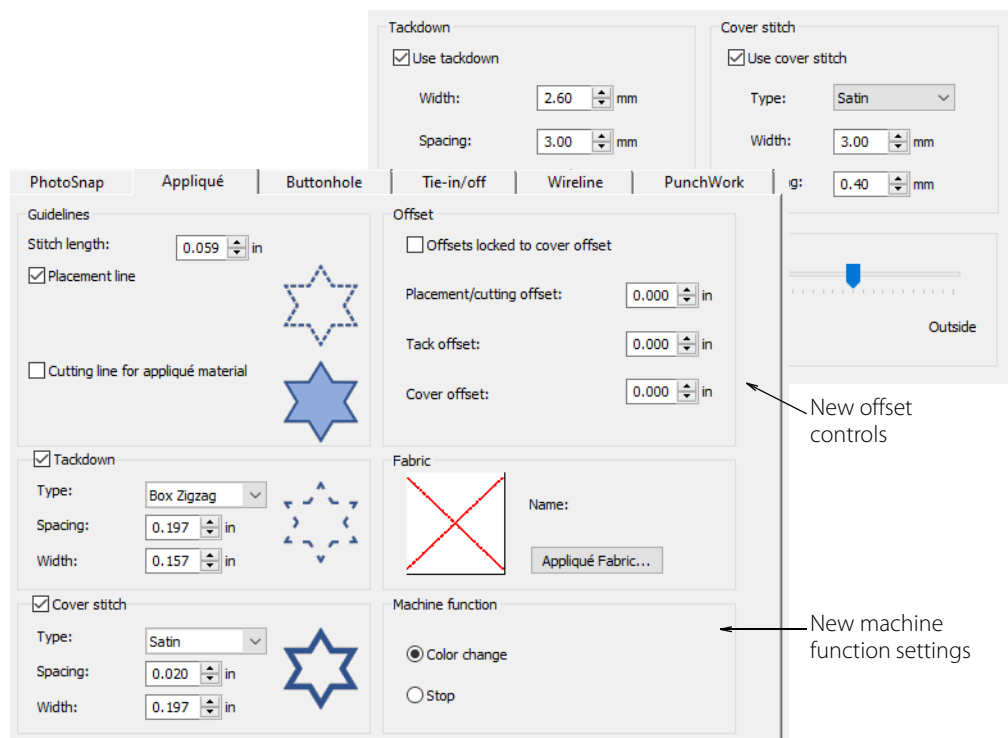

New offset controls

In the previous version, a single offset slider control was available for all appliqué components – guidelines, tackdown, and cover stitching. BERNINA Embroidery Software 9 allows you to set individual offsets for placement/cutting line, tackdown and cover stitching. This is handy depending on where you want to position cover stitching in relation to fabric edge. This may change depending on whether you intend to trim-in-place or place pre-cut patches. Or it may change with the type of tackdown stitch you are using.

New machine function settings

Depending on your machine type, a specific function may be needed to trigger the next appliqué component. This may be specified as a 'Color Change' or 'Stop' function.



Note In BERNINA V9, the frame-out position is always placed under appliqué cover stitches by default. The **Options > Appliqué & PunchWork** tab is now called **PunchWork** and all settings relate to punchwork only.

Related topics...

- ▶ [Adjust appliqué stitch settings](#) (Reference Manual)

New Appliqué tools



Use Appliqué > Digitize Appliqué with Holes to digitize closed-object appliqué with all necessary stitching with multiple boundaries.



Use Appliqué > Convert to Appliqué to use to convert selected closed objects into individual appliqués.



Use Appliqué > Combine Appliqué to break apart appliqué into component objects and recombine and resequence for efficient stitchout.



Use Appliqué > Export Cutting File to export the current design or selected objects to SVG or EXP file format for cutting.

The following new tools have been added to the **Appliqué** toolbox:

- ▶ The **Digitize Appliqué with Holes** allows you to digitize closed-object appliqué with all necessary stitching with multiple boundaries.
- ▶ The **Convert to Appliqué** tool is enabled when at least one closed non-appliqué object is selected.
- ▶ The **Combine Appliqué** tool is enabled when two or more appliqué objects are selected.
- ▶ The **Export Cutting File** tool lets you export the current design or selected objects to SVG or EXP file format for cutting.

Related topics...

- ▶ [Create appliqué with holes](#) (Reference Manual)
- ▶ [Convert to appliqué](#) (Reference Manual)
- ▶ [Combine appliqué pieces](#) (Reference Manual)
- ▶ [Exporting cutting lines](#) (Reference Manual)

Improved cutwork & stumpwork

BERNINA Embroidery Software 9 provides a reorganization and simplification of the **CutWork** and **StumpWork** toolboxes.

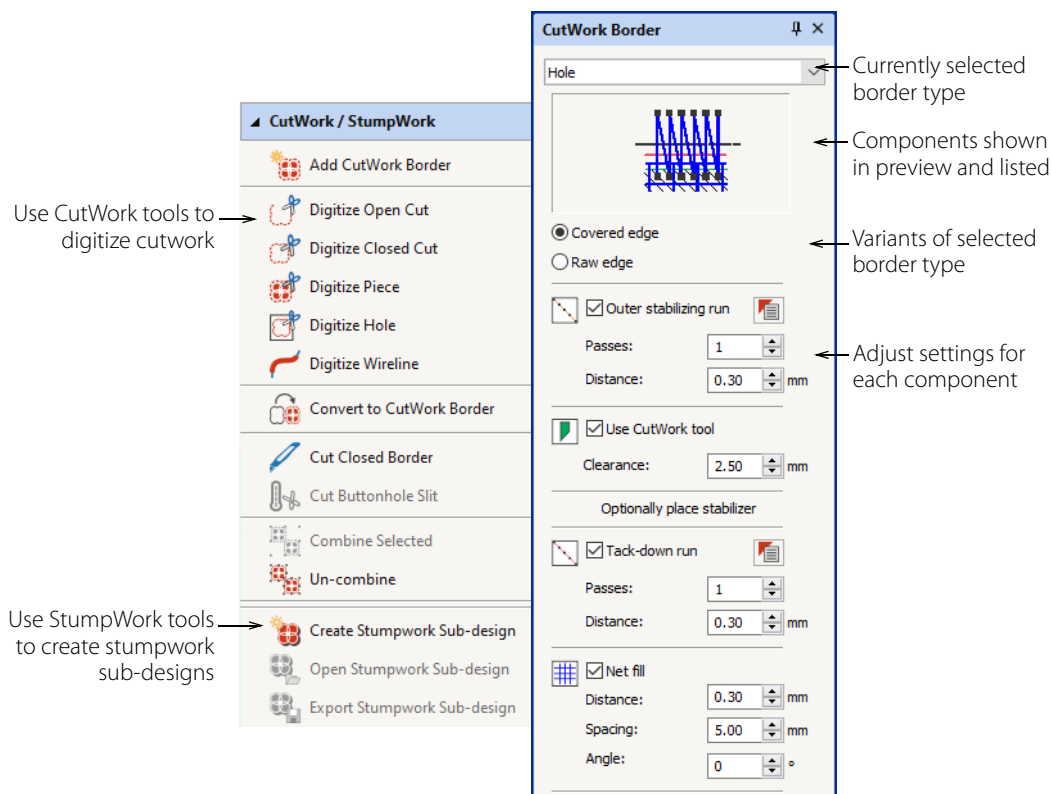

In a nutshell...

- ▶ Cutwork and stumpwork functions have been combined into a single **CutWork/StumpWork** toolbox.
- ▶ The **Digitize Cut** tool has been separated into two complementary tools – **Digitize Open Cut** and **Digitize Closed Cut**.
- ▶ The **Digitize Piece** tool now prompts you to cut a closed border if 'wireline' embroidery is selected, similar to the **Add CutWork Border** tool.
- ▶ The new **Convert to CutWork Border** tool allows you to convert individual objects to cutwork borders.
- ▶ The 'combine' functions – **Combine Selected** and **Un-combine** – have been moved from the docker and incorporated into the toolbox as explicit tools.
- ▶ Hole-1, 2, 3, 4, 5 border types have been combined into a single **Hole** border type with covered edge and raw edge.

Related topics...

- ▶ **Cutwork interface** (Reference Manual)
- ▶ **Digitizing cutwork** (Reference Manual)
- ▶ **Create cutwork borders from existing embroidery** (Reference Manual)
- ▶ **Creating stumpwork** (Reference Manual)
- ▶ **Create stumpwork with wirelines** (Reference Manual)

Improved auto-digitizing

Auto-digitizing in BERNINA Embroidery Software 9 has undergone improvements in image preparation.

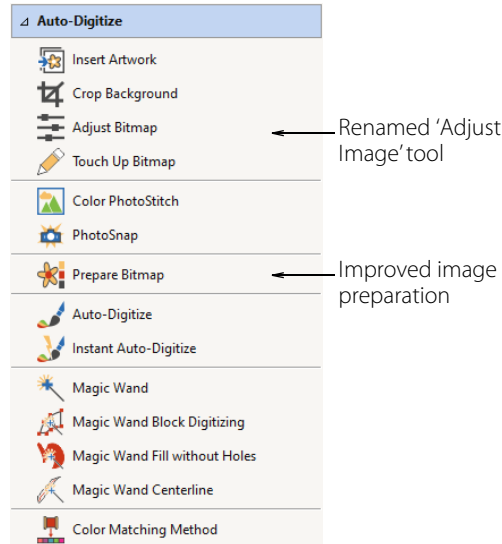

Improved bitmap preparation

 Use Auto-Digitize > Prepare Bitmap to prepare bitmap artwork for automatic digitizing.

The **Bitmap Artwork Preparation** tool has undergone a name change and functionality improvements. The function can now be run from the **Auto-Digitize** toolbox via the new **Prepare Bitmap** button. Use the tool, as before, to prepare images for automatic digitizing. BERNINA V9 provides improved color reduction and outline sharpening, making it easier for the software to recognize distinct areas in the artwork. Improved image preparation generally leads to better embroidery results.

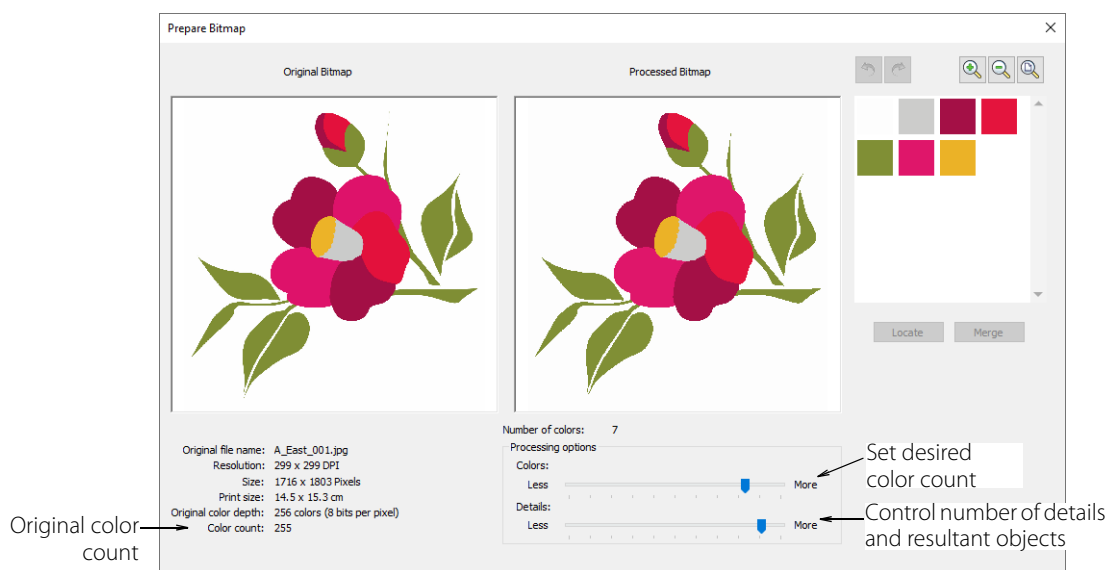

Related topics...

- ▶ [Preparing images for auto-digitizing](#) (Reference Manual)

Improved artwork conversion



Use Canvas > Convert Embroidery to Artwork to convert selected embroidery objects to vector or bitmap artwork.

The **Convert Embroidery to Artwork** tool has been improved to convert selected **embroidery objects** to **vectors** or now to **bitmaps**. Vectors can be saved out and used in other applications. 'Virtual embroidery' bitmaps can be used in design catalogs or sharing on social media.

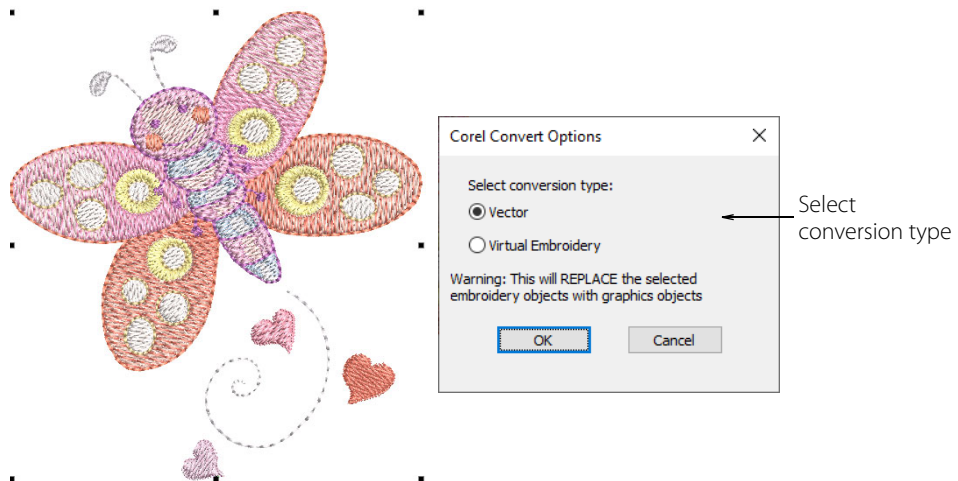

Related topics...

- ▶ [Convert embroidery to artwork](#) (Reference Manual)

Image transparency

Support is provided for transparent backgrounds in 24 bit and 32 bit images.

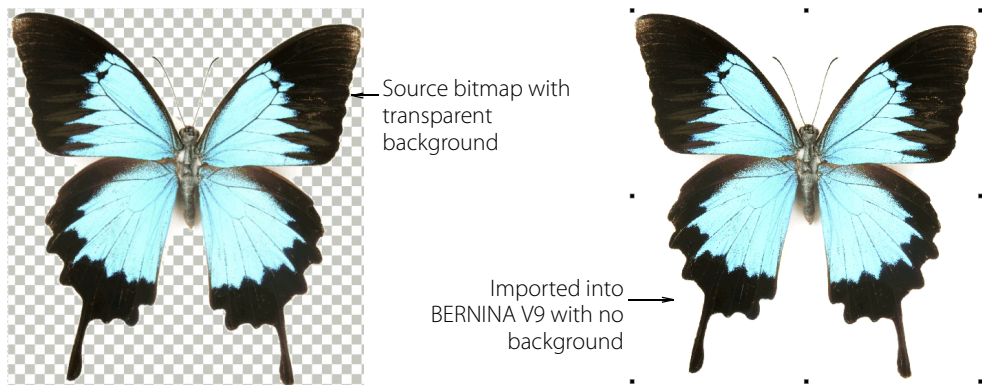

Related topics...

- ▶ [Image transparencies](#) (Reference Manual)

Improved editing

BERNINA Embroidery Software 9 provides improved editing capabilities:

- ▶ Branching
- ▶ Apply Closest Join
- ▶ Weld

Edit toolbox



Use Edit > Branching to automatically sequence and group selected embroidery objects.



Use Edit > Apply Closest Join to join selected objects at the closest point. Re-apply closest join after editing.



Use Edit > Weld to merge selected overlapping objects into a single 'flattened' object.

New **Branching**, **Apply Closest Join** and **Weld** tools have been added to the **Edit** toolbox, as shown:

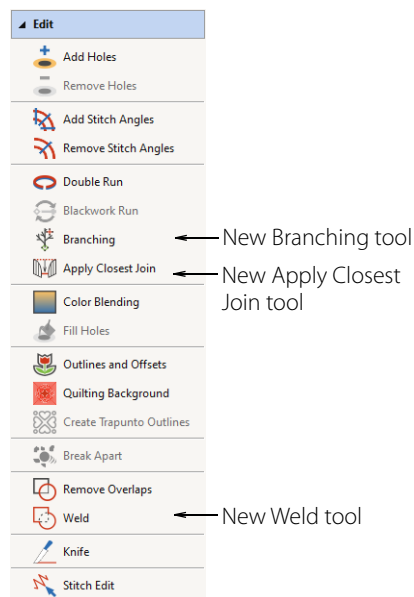

Note The existing **Remove Appliqué Overlaps** tool has been moved to the new **Appliqué** toolbox.

Related topics...

- ▶ **Minimizing connectors** (Reference Manual)
- ▶ **Automatic branching** (Reference Manual)
- ▶ **Weld objects** (Reference Manual)

Duplicate objects

Objects can be duplicated rather than copied. There are three existing techniques available for this – the **Quick Clone** feature, the **Duplicate** option, and the **Duplicate with Offset** option. The methods remain but the behaviors have changed a little as follows...

- ▶ To 'quick clone', hold down the right mouse button and drag to a new position, as before.

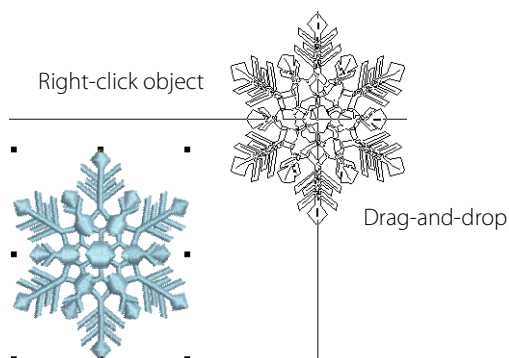

- ▶ To repeat the operation, you now use **Edit > Duplicate** or press **Ctrl+D** to create a duplicate at the same offset as the clone.
- ▶ The **Duplicate with Offset** option offsets the duplicate from the original by a fixed amount.

Related topics...

- ▶ [Duplicate objects](#) (Reference Manual)

Outlines & offsets



Use **Edit > Outlines & Offsets** to create outlines and offsets of any type for any embroidery object, open or closed.

The **Outlines & Offsets** tool is used for quickly generating new outlines and offset objects based on existing objects. The tool can now be applied to open objects as well as closed.

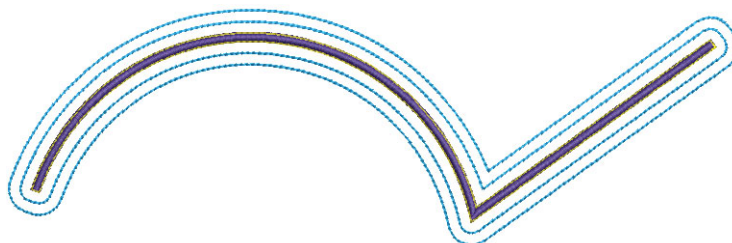

Related topics...

- ▶ [Creating outlines & offsets](#) (Reference Manual)

Improved hoop rotation



Use **Transform > Rotate Hoop 15°** to rotate the hoop and/or hoop template, or currently selected hoops in multi-hooping mode, in 15° increments to left or right.



Use **Transform > Rotate Hoop** to rotate the hoop and/or hoop template, or currently selected hoops in multi-hooping mode, by specified amount – positive or negative – in degrees.

You can now easily rotate the hoop and/or hoop template for a single-hooped design in **Embroidery Canvas** using the hoop rotation tools on the **Transform** toolbar. Use the same tools to rotate selected hoop/s in multi-hooping mode.

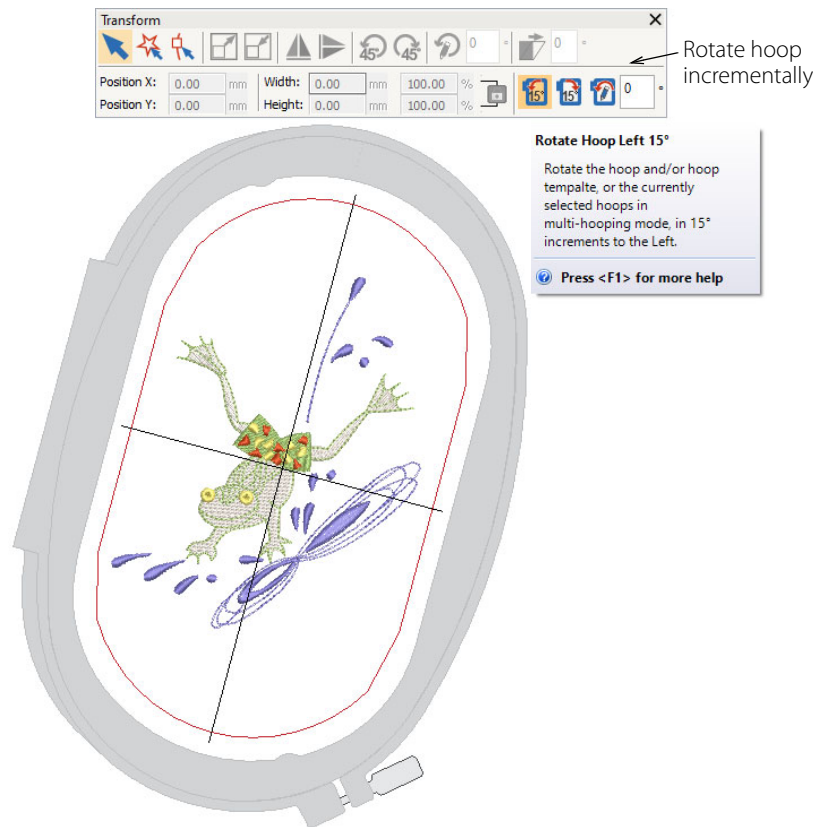

Tip The existing rotation controls on the **Transform** toolbar now only apply to split-lines in multi-hooping mode. You can still manually rotate selected hoops in multi-hooping mode.

Related topics...

- ▶ [Rotate hoops](#) (Reference Manual)
- ▶ [Create manual multi-hoopings](#) (Reference Manual)

New BERNINA WiFi Connector & Device

New BERNINA WiFi Connector and Device technology allows you to wirelessly transfer embroidery designs from BERNINA V9 to USB-enabled embroidery machines. Machine files

are automatically generated and sent via a standard WiFi network to an BERNINA WiFi Device plugged into a compatible machine. Design transfers are securely encrypted.

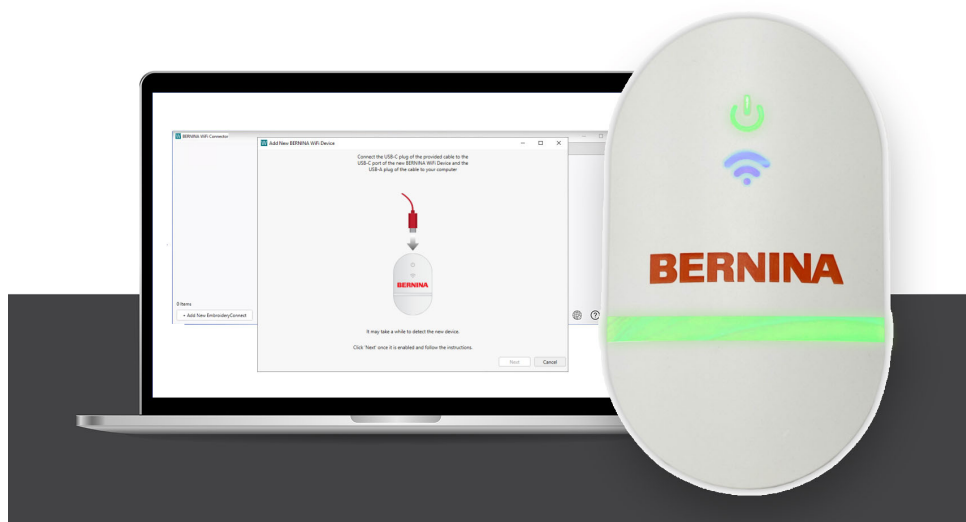

The BERNINA WiFi Device simplifies the process of managing design files for multiple machines. In these cases, you can simplify operations by networking machines to your BERNINA V9 software via dedicated BERNINA WiFi devices. The BERNINA WiFi Connector application allows you to:

- ▶ Set up and delete device(s) connected with the software.
- ▶ Send designs to multiple BERNINA WiFi devices via a WiFi network.
- ▶ View and delete designs that have been sent to BERNINA WiFi devices.
- ▶ Read designs from BERNINA WiFi devices.
- ▶ Set the memory limit of the device(s).
- ▶ Specify the file format(s) at the time of sending a design to device.



Note The BERNINA WiFi Device is bundled with BERNINA DesignerPlus and sold separately for BERNINA Creator users and those customers who need more than one. The BERNINA WiFi Connector application is standard to all BERNINA V9 software.

Related topics...

- ▶ [Machine Networking](#) (Reference Manual)
- ▶ [Network overview](#) (Reference Manual)
- ▶ [BERNINA WiFi Device setup](#) (Reference Manual)

Miscellaneous improvements

BERNINA Embroidery Software 9 provides a number of other software improvements.

Design grades indicated on Status bar

The design grade of the current design is now indicated on the **Status** bar of the **Embroidery Canvas**. BERNINA V9 designs are classified in four grades – A, B, C, and D – depending on how the file was created.

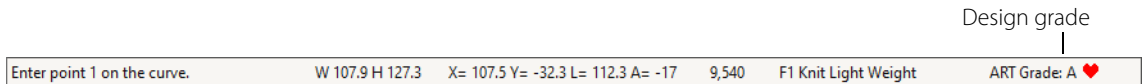

Related topics...

- ▶ **Status bar** (Reference Manual)
- ▶ **Embroidery files** (Reference Manual)

Updated Options > General tab

The **General** tab of the **Options** dialog has been updated...

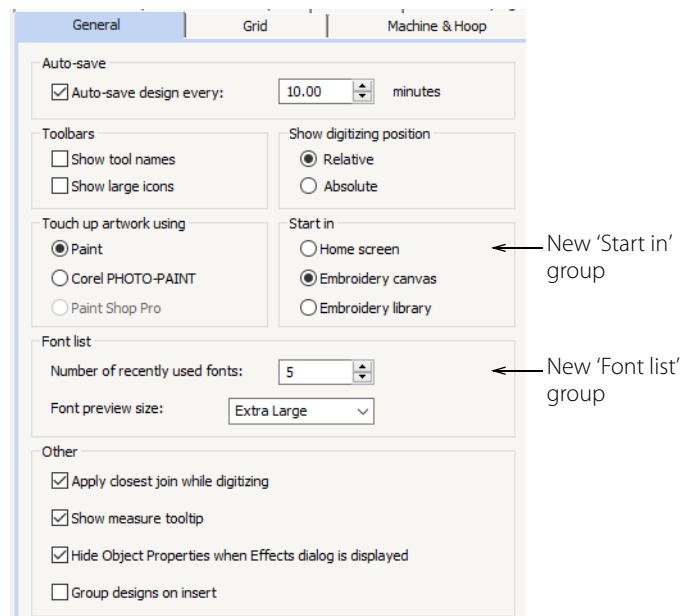

The tab now includes:

- ▶ A **Start in** group which allows you to set the start screen default – currently the new **Home** screen.
- ▶ A **Font list** group which allows you to specify font preview size – default 'Extra Large' – and number of recently used fonts – default '5'.

Related topics...

- ▶ **Set start screen** (Reference Manual)
- ▶ **Font list display options** (Reference Manual)

New inclusions

BERNINA Embroidery Software 9 provides a variety of improvements in design and other inclusions.

Design inclusions

BERNINA DesignerPlus now incorporates 930 embroidery designs and almost 500 artwork images.

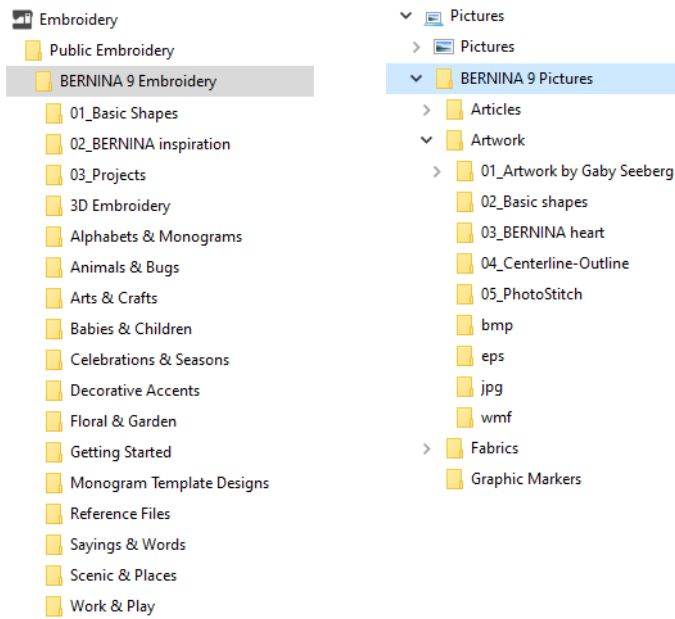

Use **Embroidery Library** to explore the new design inclusions. Over 150 new designs have been added.



Related topics...

- ▶ [Managing Designs](#) (Reference Manual)

Embroidery fonts

In BERNINA Embroidery Software 9, embroidery alphabets are now referred to as 'fonts'. Native fonts are digitized for use with embroidery. Graphic TrueType fonts from Windows and other sources are converted to stitching upon use.



BERNINA V9 includes many new embroidery fonts, making a total of more than 100 native embroidery fonts in the software. New fonts include...

- ▶ Amalfi Coast
- ▶ Locker
- ▶ Moly
- ▶ Shella
- ▶ Sm Run script
- ▶ Swiss Run Hollow



Note Farsi and Arabic TrueType fonts can now be used with BERNINA V9 and converted to embroidery fonts. There may be some exceptions depending on the font.

Related topics...

- ▶ [Embroidery Fonts](#) (Reference Manual)

Keyboard design collections

The **Keyboard Design Collection** feature provides a number of purpose-made character design collections:

- 11652 Uniquely Plaid Letters 1
- 12452 Damask Alphabet ← Packaged KDC alphabets
- 12488 Charming Numbers
- 12494 Quilted Alphabet
- 12772 Etched Alphabet

These are located as dedicated sub-folders within the **Alphabets & Monograms** folder of your BERNINA embroidery samples.

Related topics...

- ▶ [Keyboard design collections](#) (Reference Manual)

Sample patterns

BERNINA Embroidery Software 9 includes six (6) new categories of pattern:

- ▶ Banner
- ▶ Children2
- ▶ Decoration
- ▶ Hobby & Sport
- ▶ Nature_2
- ▶ Seasons

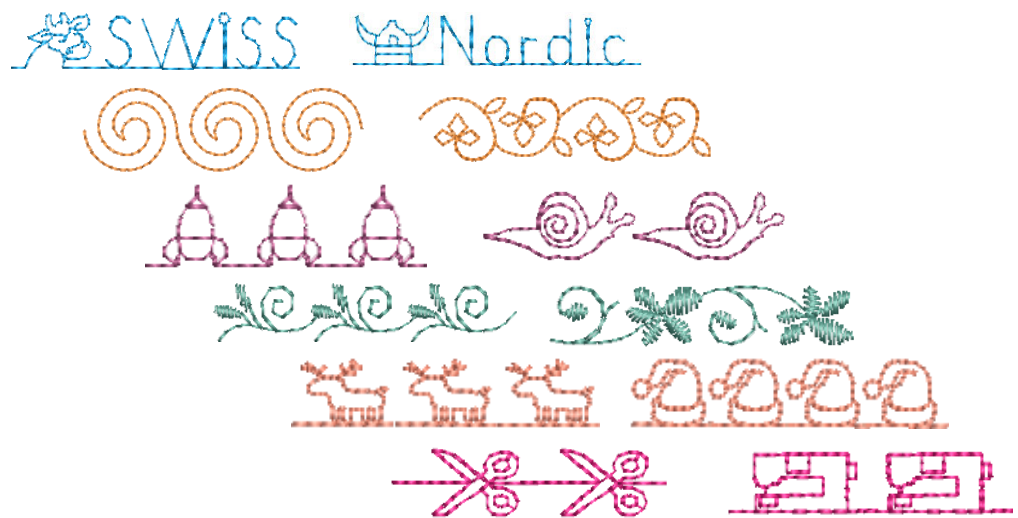

Explore these via the **Digitize > Pattern Stamp** dialog.

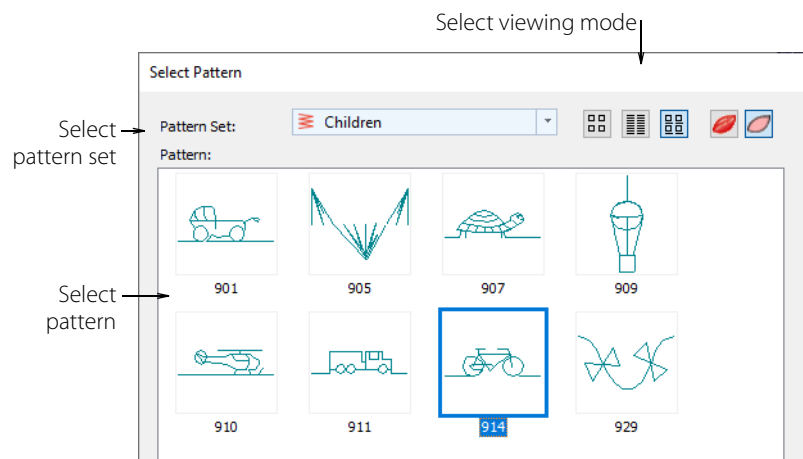

Related topics...

- ▶ [Embroidery Patterns](#) (Reference Manual)
- ▶ [Pattern Stamp, Run & Fill Samples](#) (Reference Manual)

BERNINA EMBROIDERY SOFTWARE 9 UPDATES

Since the initial release of BERNINA Embroidery Software 9, a number of improvements and fixes have been introduced into software updates.

V9.2 improvements

BERNINA Embroidery Software V9.2 update benefits from the following improvements...

Send & receive files from the B 990 via WiFi



Use General > Write to Card/Machine to write (save) design to BERNINA design card or BERNINA embroidery machine.



Use General > Read from Card/Machine to read design from BERNINA design card or BERNINA embroidery machine.

With the latest release, you can now send and receive files directly to and from the BERNINA 990 machine via WiFi connection:

- ▶ A new **Read from Card/Machine** icon is now available on the **General** toolbar.

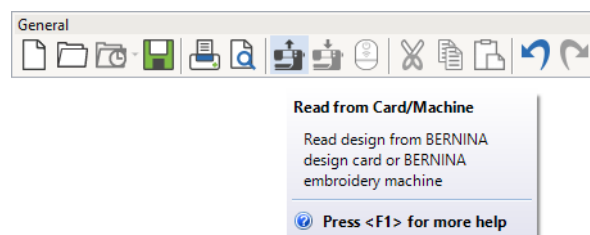

- ▶ Send designs directly to **B 990** via WiFi-connectivity without using the BERNINA WiFi Device.

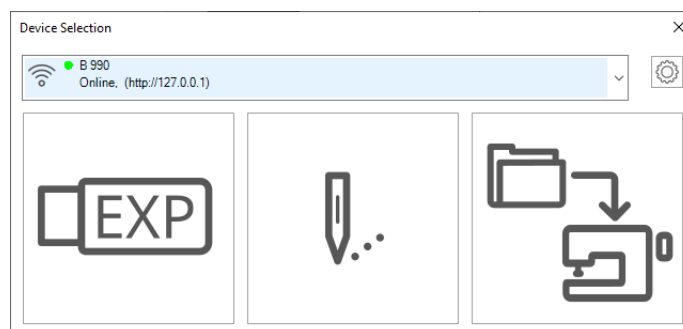

Send designs directly to 'Stitchout' screen or save to 'My designs' folder

- ▶ Save designs to the **Personal Folder** folder of B 990.



Tip Refer to the [BERNINA Youtube channel](#) for related videos.

Related topics...

- ▶ [Reading & writing designs](#) (Reference Manual)

- ▶ **Stitching out designs** (Reference Manual)

Open scanned hoop from the B 990 machine



Use General > Read from Card/Machine to open scanned images from the B 990 embroidery machine.

With the latest release, you can open scanned images from the **B 990** machine in **Embroidery Canvas**. The image can be used to adapt the embroidery design or position it accordingly.

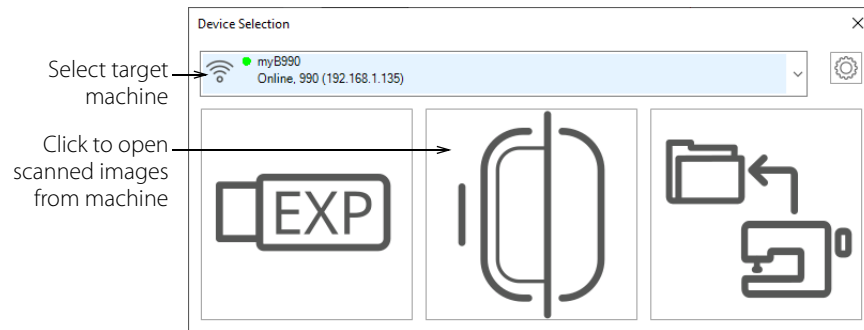

- ▶ The new scanning feature is only available on the **B 990** machine.
- ▶ Click the middle button to read scanned images into BERNINA Embroidery Software 9.
- ▶ After the scanned image has been read into the **Embroidery Canvas**, the embroidery design can be resized, reshaped or positioned in relation to the scanned image and then sent to machine.

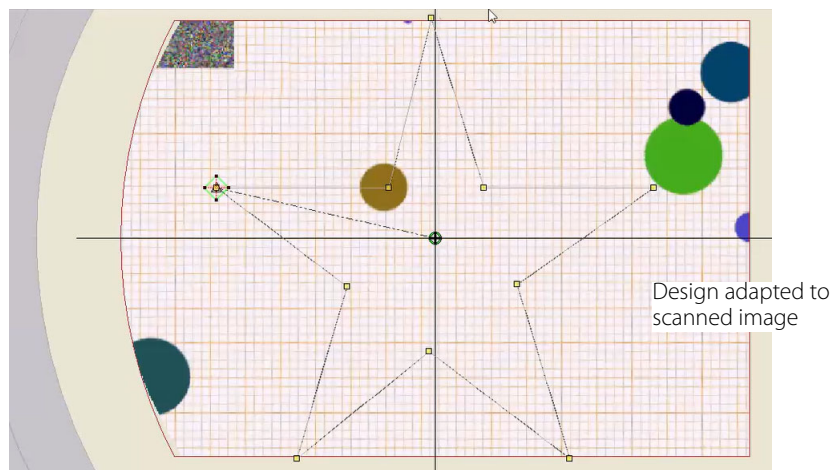

Tip Refer to the [BERNINA Youtube channel](#) for related videos.

Related topics...

- ▶ **Read scanned hoops from machine** (Reference Manual)

New BERNINA machine & embroidery hoop

With the latest release, the new BERNINA 990 machine and Giant hoop, available from 2024, are included in the software.

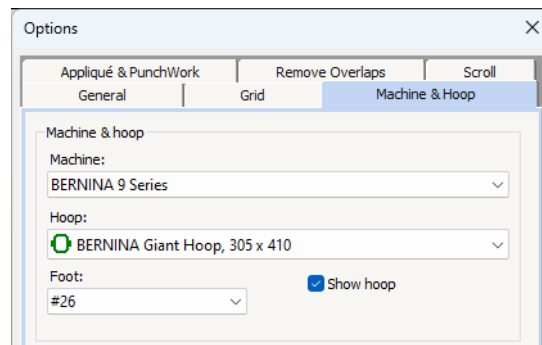

New BERNINA 990 machine and Giant hoop available

Related topics...

- ▶ [Setting machine & hoop options](#) (Reference Manual)
- ▶ [Device selection & setup](#) (Reference Manual)
- ▶ [Selecting hoops](#) (Reference Manual)

New 'Keep Hoop Position' feature



Click View > Keep Hoop Position to keep the hoop in position when placing the design. When toggled off (the default), the hoop is automatically centered around the design.

The BERNINA Embroidery Software 9.2 Update includes a new feature to maintain the design position within the hoop when sent to machine. The toggle allows you to place the design at a specified position for the newer BERNINA models which support this option. You might do this to set up continuous designs or special placements such as on pockets.

- ▶ The new **Keep Hoop Position** toggle appears on the **View** toolbar.



Keep Hoop Position

Hoop is kept in position if toggled on or automatically centered around the design if toggled off.

Press <F1> for more help

- ▶ The setting also needs to be activated on the machine:

- ▶ Setting in **B 790 Pro** and other BERNINA models...

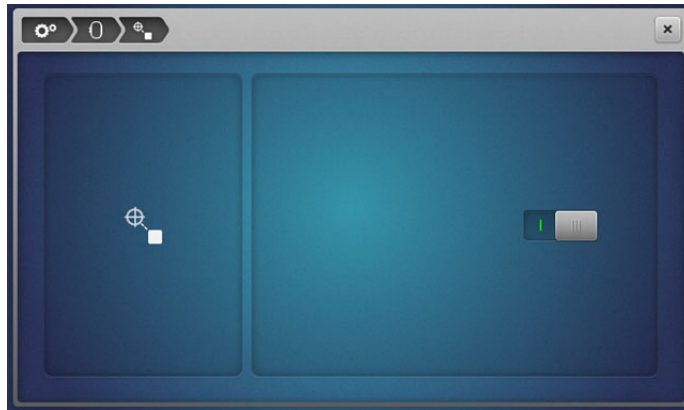

- ▶ Setting in **B 990**...

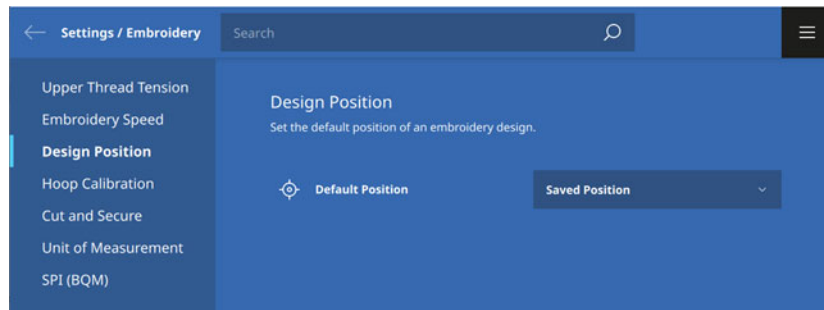

Related topics...

- ▶ [Center hoops](#) (Reference Manual)
- ▶ [Positioning & production techniques](#) (Reference Manual)

Updated 'Auto Start and End' and 'Hoop Position' controls

The new **Keep Hoop Position** command has necessitated changes to 'Auto Start and End' and 'Hoop Position' controls.

Auto Start and End dialog

The **Auto Start and End** dialog has been updated as shown...

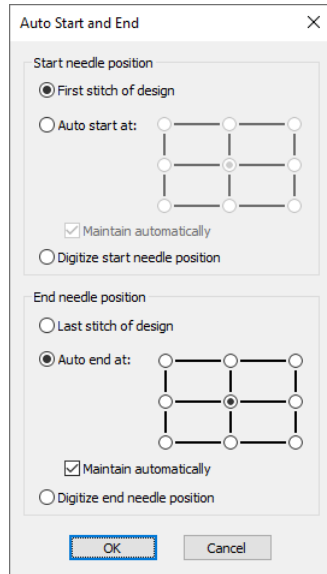

Auto Start and End v9.0

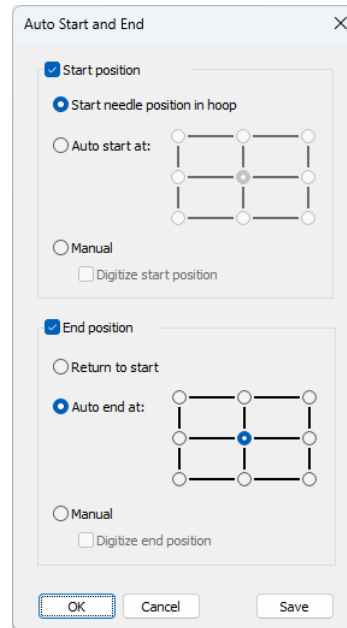

Auto Start and End v9.2

Machine & Hoop dialog

The **Hoop position** controls in the **Options > Machine & Hoop** dialog have been updated as shown...

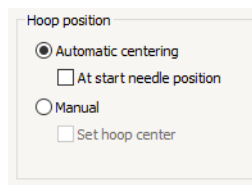

Hoop position controls v9.0

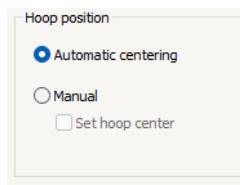

Hoop position controls v9.2

Related topics...

- ▶ [Automatic start & end points](#) (Reference Manual)
- ▶ [Center hoops](#) (Reference Manual)

New presser foot #72

With the latest release, the presser foot #72 can now be selected in the software.

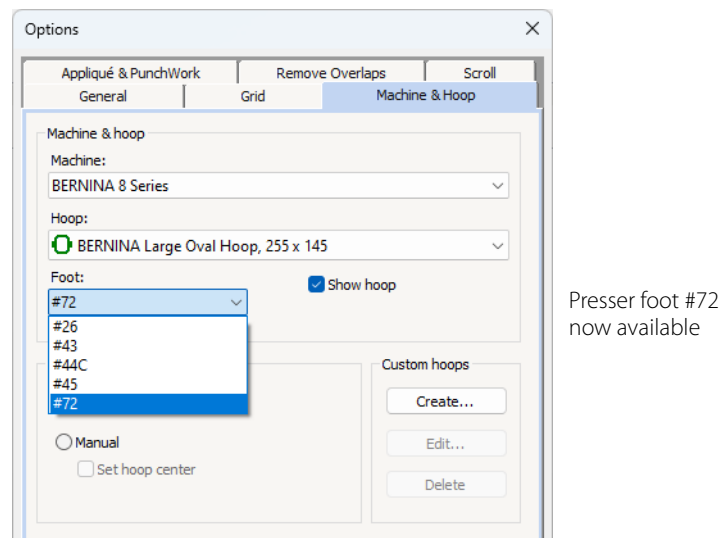

When the presser foot is mounted, the available embroidery area will display on the machine when selected in the software.

Related topics...

- ▶ [Setting machine & hoop options](#) (Reference Manual)
- ▶ [Device selection & setup](#) (Reference Manual)

New user interface language

With the latest release, Portuguese can now be selected as the user interface during installation. Select 'Português brasileiro' from the list of additional languages.

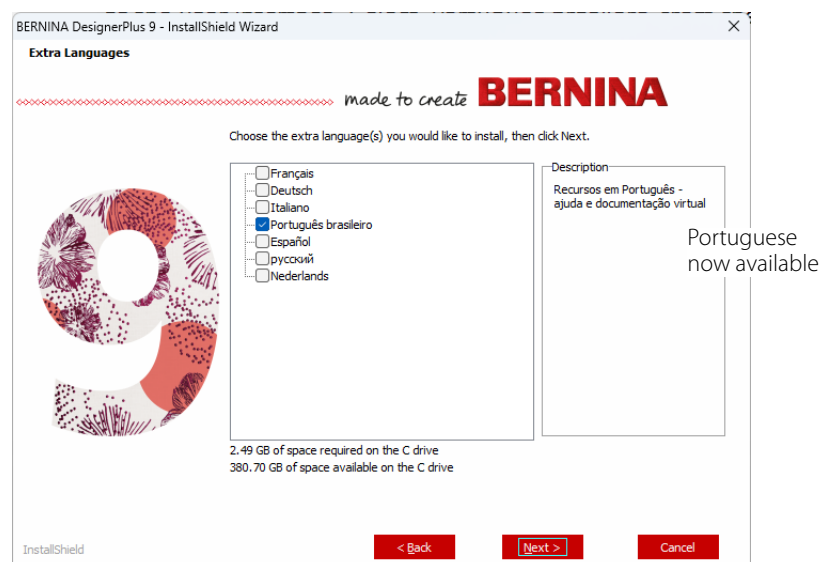

After installation you can switch to Portuguese from the BERNINA V9 program group in the Windows App list.

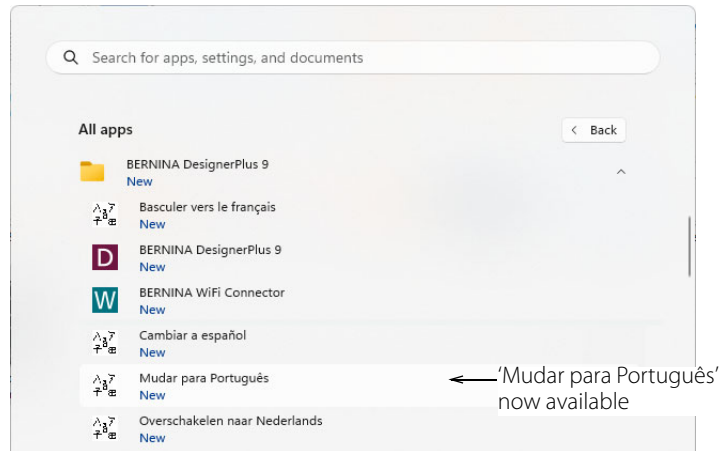



New driver for Aurora machines

The BERNINA Embroidery Software 9.2 Update now provides the latest driver for Aurora machines, allowing secure installation on Windows 10 & 11 operating systems.

V9.1 improvements

BERNINA Embroidery Software V9.1 update benefits from the following improvements...

Send & receive files from the B 790 PRO via WiFi

-  Use General > Write to Card/Machine to write (save) design to BERNINA design card or BERNINA embroidery machine.
-  Use General > Read from Card/Machine to read design from BERNINA design card or BERNINA embroidery machine.

With the latest release, you can now send and receive files directly to and from the 'BERNINA 790 PRO' via WiFi connection:

- ▶ Send designs directly to **B 790 PRO** via WiFi-connectivity without using the BERNINA WiFi Device.

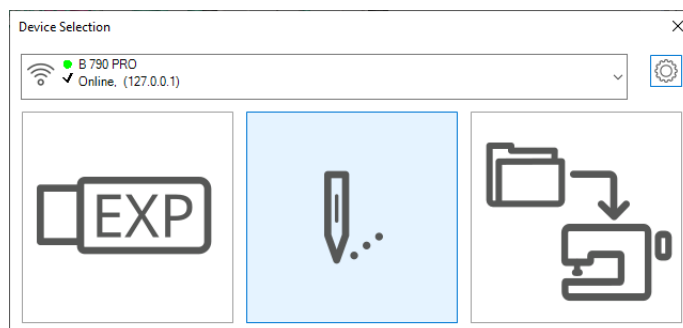

Send designs directly to 'Stitchout' screen or save to 'My designs' folder

- ▶ Save designs to the 'My Design' folder of B 790 PRO.

- ▶ Open designs (EXP-format) directly from machine to the V9 **Embroidery Canvas**.

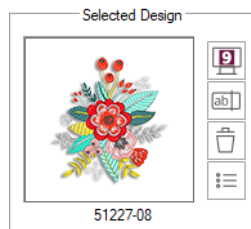

Open designs from machine directly in V9 or save to PC

Related topics...

- ▶ [Reading & writing designs](#) (Reference Manual)
- ▶ [Stitching out designs](#) (Reference Manual)

New BERNINA hoops

With the latest release, the following new BERNINA hoops, available from 2023, are included in the software:

- ▶ BERNINA Small Clamp Hoop 6.5 x 6.5
- ▶ bernette Magnetic Hoop 100 x 100
- ▶ bernette Magnetic Hoop 130 x 180
- ▶ bernette Magnetic Hoop 140 x 260

Lettering improvements

BERNINA Embroidery Software 9 provides the following lettering improvements...

3D Drummon font

Stitching in the 3D Drummon font has been improved.



Font sizes

Recommended font sizes in the software and reference manual are now consistent. See [Embroidery Fonts](#) (Reference Manual).

V9.0.3 improvements

BERNINA Embroidery Software V9.0.3 update benefits from the following improvements...

Hooping improvements

BERNINA Embroidery Software 9 provides the following hooping improvements...

New BERNINA hoops

With the latest release, new BERNINA hoops, available from September 2022, are included in the software. These are:

- ▶ BERNINA Large Freearm Hoop
- ▶ BERNINA Medium Clamp Hoop

New 'BERNINA 5 series' machine hoop category

With the latest release, the 'BERNINA 5 Series' has been renamed: 'BERNINA 5 series 555/560/570 QE/580 (LUN)'. The 'BERNINA Midi Hoop' has been deleted from this category. A new 'BERNINA 5 Series 500/535/540/570 QE/590 (VIO)' machine category has been added. The new 'BERNINA Large Freearm Embroidery Hoop' has been added to this series.

Lettering improvements

BERNINA Embroidery Software 9 provides the following lettering improvements...

Letter spacing

In the previous release, letter spacing in some fonts became compacted. This problem has been rectified with the latest update.



Embroidery designs in the KDC docker

In the previous release, some embroidery designs were not visible in the **Keyboard Design Collection** docker. The workaround was to turn off the automatic corners. This problem has been rectified with the latest update.

Artwork and auto-digitizing improvements

BERNINA Embroidery Software 9 provides the following artwork and auto-digitizing improvements...

Touch up artwork using Windows Paint

In the previous release, the 'Touch up bitmap using Paint' option on the Options > General tab was disabled on the Windows 11 operating system. This problem has been rectified with the latest update.

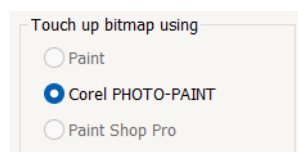

Note At the same time, the 'Touch up artwork using' label has changed to 'Touch up bitmap using'.

Touch-up artwork using Corel Photo-Paint

In the previous release, the option to touch-up artwork using Corel PHOTO-PAINT was using a previous version of the software. This problem has been rectified with the latest update.

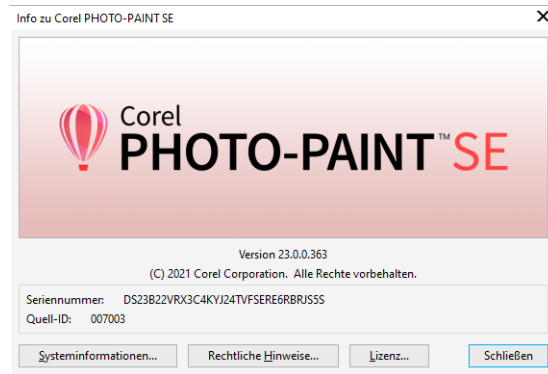

Rotating artwork with Magic Wand

In the previous release, inserted bitmaps were rotated when applying **Magic Wand** or other auto-digitizing tools. This problem has been rectified with the latest update.

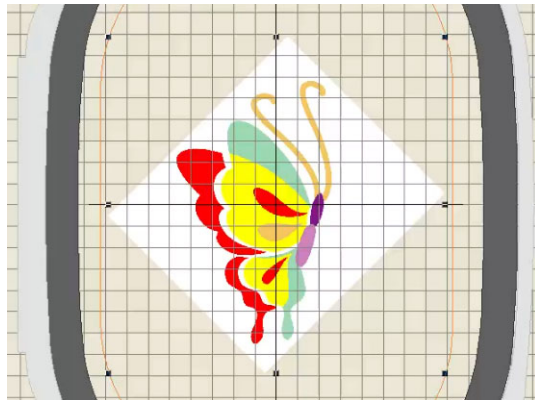

Slider control in Color PhotoStitch

In the previous release, when adjusting brightness and contrast in **Color PhotoStitch**, the numeric readout was missing. This problem has been rectified with the latest update.

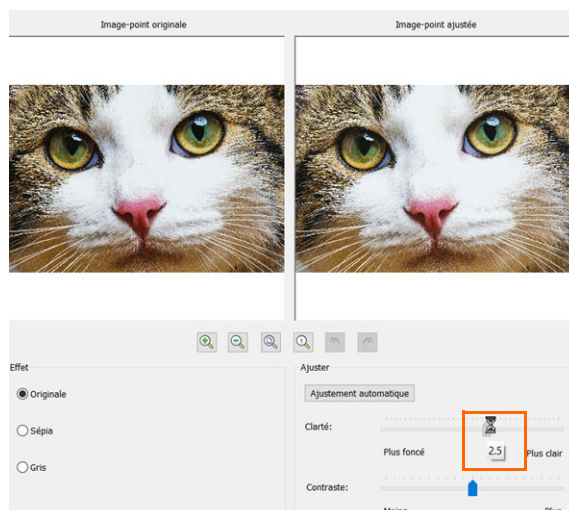

Appliqué and cutwork improvements

BERNINA Embroidery Software 9 provides the following appliqué and cutwork improvements...

Advanced appliqué fabric display

In the previous release, customers reported a problem with fabric display in **Advanced Appliqué**. When the fabric is applied and the **Show Fabric** button activated, the fabric now appears correctly.

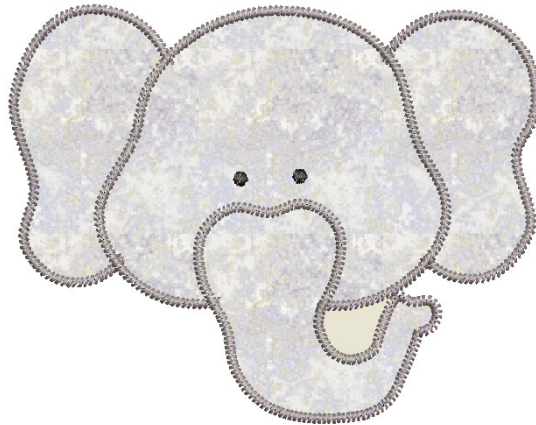

Cutwork clearance

In the previous release, the software slows down and docker functions disappear when adjusting clearance of cutting lines in cutwork objects with mouse and arrows. The software sometimes fails to respond and docker functions disappear. Tackdown and stabilizing runs are also affected. This problem has been rectified with the latest update.

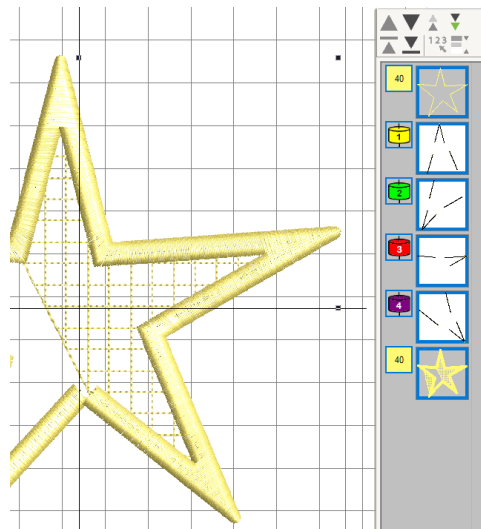

File handling improvements

BERNINA Embroidery Software 9 provides the following file handling improvements...

VIP file format

In the previous release, VIP file format was missing from the **Save as type** selection. This problem has been rectified with the latest update.

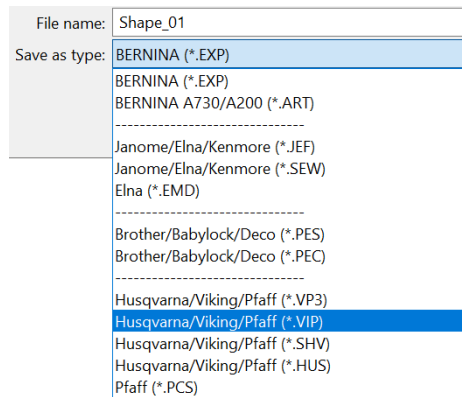

Quilter ARQ V9 designs

With the previous release, Quilter designs saved in ARQ V8 format cannot be opened in V8 Quilter. Furthermore, customers found that ARQ V9 files cannot be deleted. These problems have been rectified with the latest update.

Quilter ARQ V7.0 file format

In the current release, the Quilter save function also now includes an ARQ V7.0 option when switched to German.

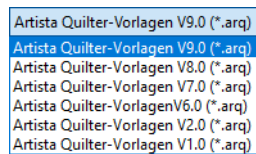

Interface improvements

BERNINA Embroidery Software 9 provides the following interface improvements...

Outline type droplist field

In the previous release, the **Outline type** droplist field in the **Object Properties** dialog is missing its outline. This problem has been rectified with the latest update.

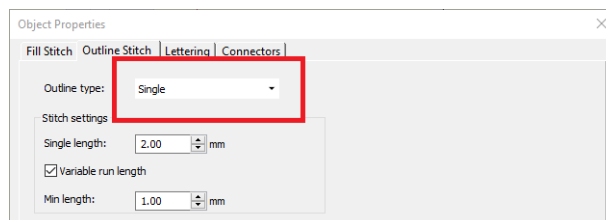

Morphing Effect docker display

In the previous release, when using the **Morphing Effect** docker, the current icon does not stay highlighted. With the current release, you will see which selection you have chosen after morphing has been applied.



Language issues

BERNINA Embroidery Software 9 provides the following language improvements...

EULA in multiple languages

With the latest release, the software EULA-documents are now available in the GUI-languages: DE, EN, ES, FR, IT, NL, RU.

German translation

The current release corrects a number of translation and truncation issues in the German software interface. It also corrects some content in the German online help.

Russian translation

The current release corrects a number of translation and truncation issues in the Russian software interface. The Russian online help is also now complete, and reference manual and release notes are available for download.

My Profile > State field during registration

In the previous release, the **State** field in the **My Profile** settings included a mix of German and English states. This problem has been rectified with the latest update.

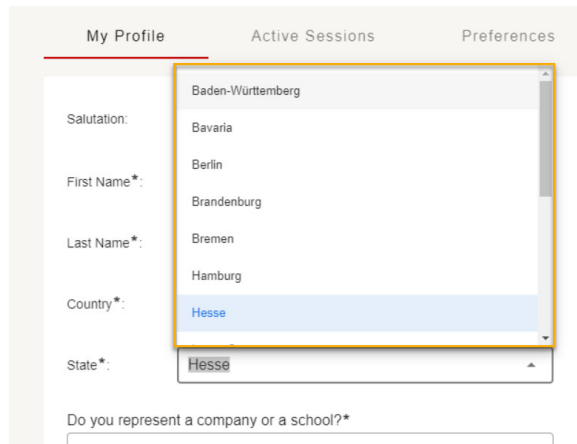

System improvements

BERNINA Embroidery Software 9 provides the following system improvements...

New HASP driver 8.43

With the latest update, a new HASP driver is now available.

Aurora 430/440 machine driver

With the latest release, the Aurora machine driver ('ftdibus.sys') is correctly placed in the driver folder.

Report an issue

In the previous release, the 'Report an issue' ZIP file did not include the WiFi-Device log file. This problem has been rectified with the latest update. The feedback reporter also includes with new support information.

Name	Date modified	Type	Size
aksdrvsetup	4/07/2022 3:21 PM	Text Document	23 KB
defaults.dfl	4/07/2022 4:16 PM	DFL File	40 KB
errlog1.MLG	4/07/2022 4:17 PM	MLG File	1 KB
Log	4/07/2022 4:17 PM	Text Document	5 KB
msinfo32_20220704161755	4/07/2022 4:18 PM	System Informatio...	1,517 KB
summary	4/07/2022 4:18 PM	Text Document	1 KB

Machine runtime calculation

With the latest release, the machine runtime calculation shown on the design worksheet has been improved to factor in the current machine and hoop selection. There are two different machine model embroidery modules which have different speed characteristics

based on stitch length – a larger module for machines like the 880 and a smaller module for machines like the 640.

Color Sequence:				
#	Color	Element	Code Name	Chart
1.	2		H-157-1063 Pale Caramel	Hemingworth
2.	3		H-001-1001 Pure White	Hemingworth
3.	1		H-028-1074 Sea Storm	Hemingworth
4.	2		H-157-1063 Pale Caramel	Hemingworth
5.	5		H-168-1141 Pumpkin Spice	Hemingworth
6.	2		H-157-1063 Pale Caramel	Hemingworth
7.	5		H-168-1141 Pumpkin Spice	Hemingworth
8.	3		H-001-1001 Pure White	Hemingworth
9.	4		H-101-1092 Key Lime	Hemingworth
10.	11		0020 Black	Isacord 40
11.	2		H-157-1063 Pale Caramel	Hemingworth
12.	5		H-168-1141 Pumpkin Spice	Hemingworth
13.	2		H-157-1063 Pale Caramel	Hemingworth

Machine runtime:	
Module	Runtime (hr:min:sec)
Large	0:20:00

Snap to grid

In the previous release, the ‘snap to grid’ option remained active even when the grid was not displayed. This problem has been rectified with the latest update.

Network connectivity improvements

BERNINA Embroidery Software 9 provides the following network connectivity improvements...

WiFi Device supports Windows 11

With the current release, the WiFi Device supports Windows 11 (64-bit edition with the latest updates) in addition to Windows 10.

Connector WiFi Device setup screen

With this release, The BERNINA Connector WiFi Device setup screen has undergone minor improvements to text placement, truncations, and so on.

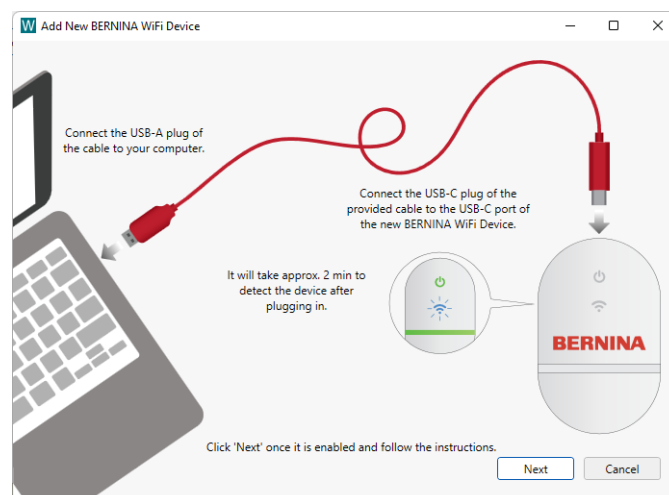

WiFi Connector startup

With the previous release, some users didn't realize that the WiFi Connector must be independently started before designs can be sent. With the latest update, WiFi Connector

runs automatically whenever BERNINA V9 is opened unless there is an instance already running on the same network.

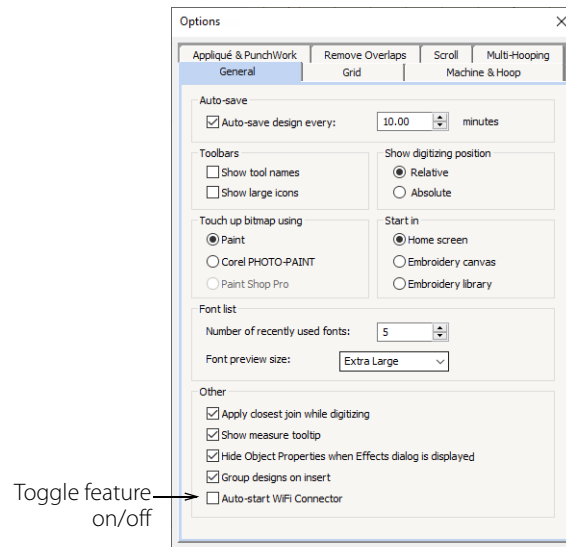

WiFi Connector auto-start limitation

Currently, the automatic update may affect the WiFi Connector auto-start checkbox. Changes in checkbox status may not be saved. This results in having to manually start the WiFi Connector. The workaround is to delete the 'defaults.dfl' file from the defaults folder...

```
C:\ProgramData\BERNINA\BERNINA  
Embroidery\<DesignerPlus 9>\DEFAULTS
```

This will then allow the checkbox to function normally.

Depending on your system configuration, the 'ProgramData' folder may be hidden. You will need to enable hidden files first via Windows® File Explorer. Moreover the 'DesignerPlus 9' folder in the path indicated may be named 'Creator 9' or 'Dealer 9' depending on your product version.



Note Deleting the default.dfl file will revert the UI to the 'as installed' layout and reset the 'keep me signed in' checkbox. This requires you to sign in again on the next start.